

WORLD WAR II MEMORIAL: FDR D-DAY PRAYER



Prepared for:

FRIENDS OF THE NATIONAL
WORLD WAR II MEMORIAL, INC

JANUARY 20, 2022

PRESENTATION TO THE
COMMISSION OF FINE ARTS
(COMMEMORATIVE FEATURE DETAILS AND REVISIONS)

TABLE OF CONTENTS



MAY 2021 CFA LETTER & AGENDA	3
GRADING	4
BENCH DESIGN	5-6
STRUCTURAL SUPPORT OF THE PRAYER PLAQUE	7
MEDALLION AND GARLAND DESIGN	8-10
LAYOUT OF PLAQUE AND INSCRIPTIONS	11-13
WALL COURSING REVISION	14
MATERIALS INDEX	15

COMMISSION OF FINE ARTS FDR PRAYER CIRCLE AGENDA

CFA 20/NOV/23-1

LOCATION: West Potomac Park, 17th Street and Independence Avenue, SW Washington, DC

OWNER: National Park Service (NPS)

PROPERTY: World War II Memorial

DESCRIPTION: Install plaque with President Franklin Delano Roosevelt's D-Day Prayer

PREVIOUS REVIEW: CFA 21/MAY/20-1

27 May 2021

Dear Ms. Hall:

In its public meeting of 20 May conducted by video conference, the Commission of Fine Arts reviewed a final design submission for alterations to the existing Circle of Remembrance at the World War II Memorial, to include a new plaque inscribed with the prayer delivered by President Franklin D. Roosevelt by radio on D-Day. Citing the resolution of the outstanding design issues, the Commission approved the final submission with the following recommendations for the various options that were presented.

In their approval action, the Commission members endorsed Alternative B for the treatment of the perimeter elements of the circle, in particular the revisions to the profile of the benches and the relationship of the bronze prayer plaque with the stone base. For the identifying inscription on this stone base at the entrance to the circle, they recommended that the text be only "A Prayer for the Nation." They also endorsed the proposed landscape design and Option 1 for the lighting design, recommending that no additional lighting poles or fixtures be installed to illuminate the plaque. Concerning the options presented for the center of the pavement within the circle, the Commission members unanimously endorsed the inclusion of the circular garland design of olive branches and five stars, suggesting that this element could be made bolder, possibly larger or located in an inner ring of the pavement; to enhance the clarity of this design, they recommended that the elements of the garland be bronze inset into the granite paving stones instead of cast as bronze panels. In their discussion of the option for a bronze medallion at the center, intended to repeat the Victory Medal design in the arches of the World War II Memorial, some Commission members raised concern that the figural composition would create an undesirable directionality to the space and would detract from the importance of the prayer plaque, while others found that the medallion as proposed has strong symbolic importance and reinforces the connection to the main part of the memorial; the Commission concluded by recommending a design featuring both the garland and the medallion.

As part of the final review process, the Commission recommended that additional details be developed and documented in coordination with the staff. These include the possible **grading of the plaza** toward a slot drain located beneath the perimeter benches; the design of any structural brackets required for the projecting **benches**; sufficient structural supports to prevent deformation of the **prayer plaque**; the design for the composition of the **medallion and garland** within the pavement; and the layout of the proposed graphic design for the plaque and **inscriptions**.

The Commission congratulates the National Park Service and the project team for their diligence in developing an elegant final design for this important addition to the World War II Memorial. Please coordinate with the staff to complete the development and documentation of the design in accordance with the final approval.

Sincerely,



Thomas E. Luebke, FAIA
Secretary

Kym A. Hall, Area Director
Region 1—National Capital Area
National Park Service
1100 Ohio Drive, SW
Washington, DC 20242

cc: Lisa Delplace, Oehme, van Sweden
Holly Rotondi, Friends of the National World War II Memorial

During the May 21st review, CFA recommended "additional details be developed in coordination with the staff:

I. Grading

- "possible grading of the plaza toward a slot drain located beneath the perimeter benches"

II. Bench Design

- "design of any structural brackets required for the projecting benches"

III. Structural Support of Prayer Plaque

- "sufficient structural supports to prevent deformation of the prayer plaque"

IV. Medallion and Garland Design

- "design for the composition of the medallion and garland within the pavement"

V. FDR Prayer Plaque and Inscriptions

- consider "layout of the proposed graphic design for the plaque and inscriptions"

VI. Wall Coursing

- finalize coursing at ends of freestanding walls

I. Grading

"...the Commission recommended that additional details be developed, [including], the possible **grading of the plaza** toward a slot drain located beneath the perimeter benches..."

- Drains are located to the east and west of the entry and under the plaque
- Drain grates are fabricated from bronze for durability

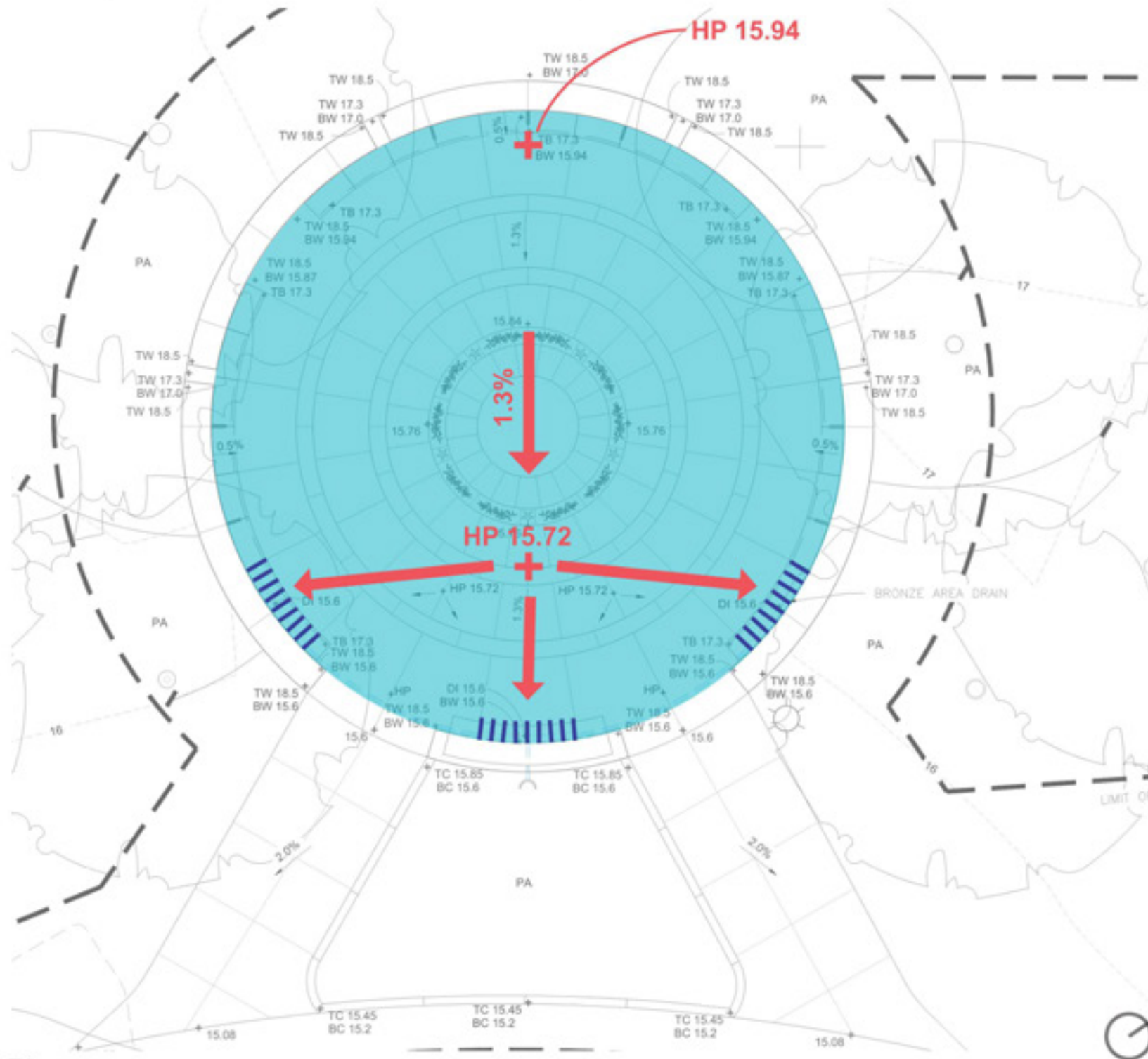

Plan
scale: 1/8" = 1'-0"

Drain Grate

Semi-custom Bronze Grate (variable patina finish to be discrete beneath bench and plaque)

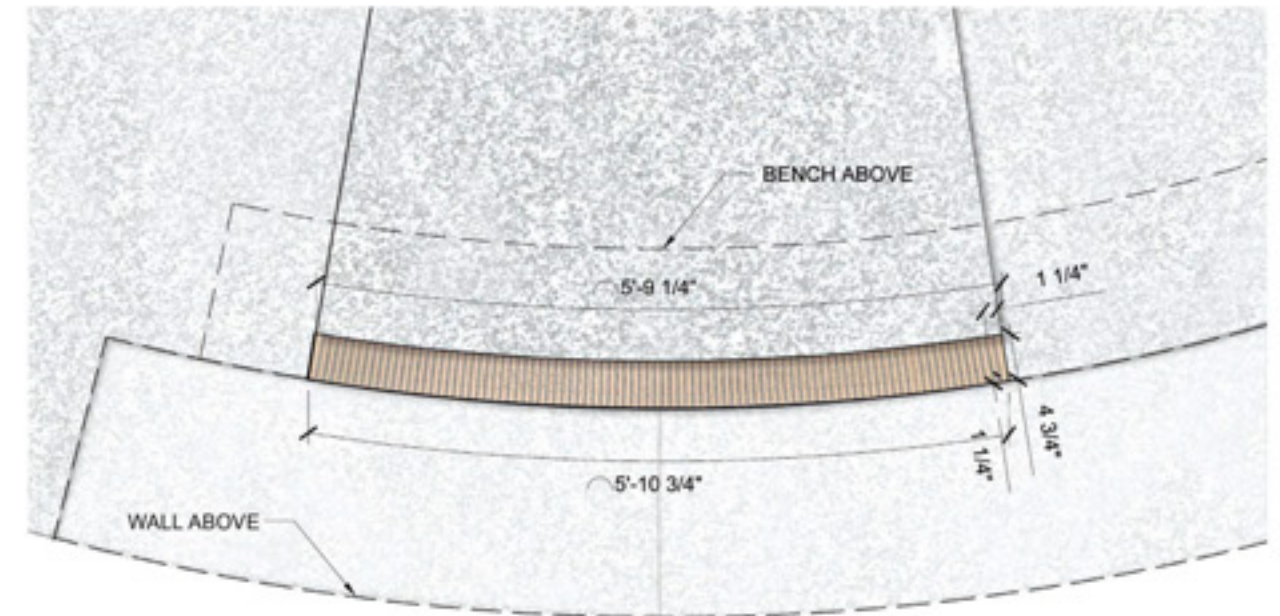

Enlarged Plan (rendered)
scale: NTS

II. Bench Design

"...the Commission recommended that additional details be developed, [including], the design of any structural brackets required for the projecting benches..."

- Bench supports shall be stainless steel plates, inset into the bench stones
- Supports shall not be visible from above



Precedent Image

scale: NTS

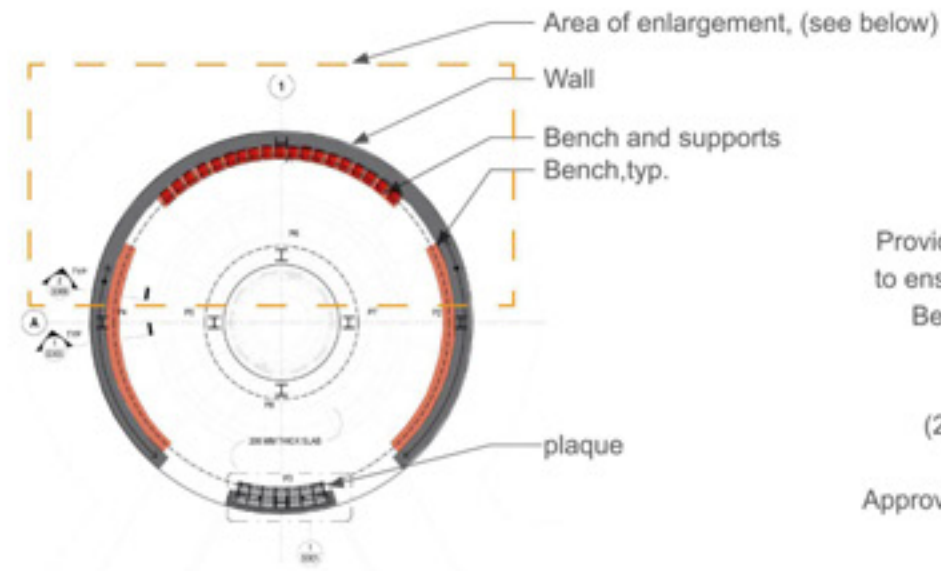

Plan Key

scale: NTS

Provide Shims as needed to ensure tight fit between Bent Plate and Curved Face of Concrete

(2) - 1/2" DIA. SS Hilti Kwik Bolt Anchor or Approved Equal @ 8" O.C.

Exterior Grade Elevation Varies
New Concrete Haunch

Stone Cladding, see LA

Stone Bench, see LA

Grade 316 SS Plate Per Plan
Coordinate Edge of Plate with Cove Light, See LA

Roughen Surface to 1/4" Amplitude, Typ.
Existing Slab to Remain

Existing Foundation Slab to Remain

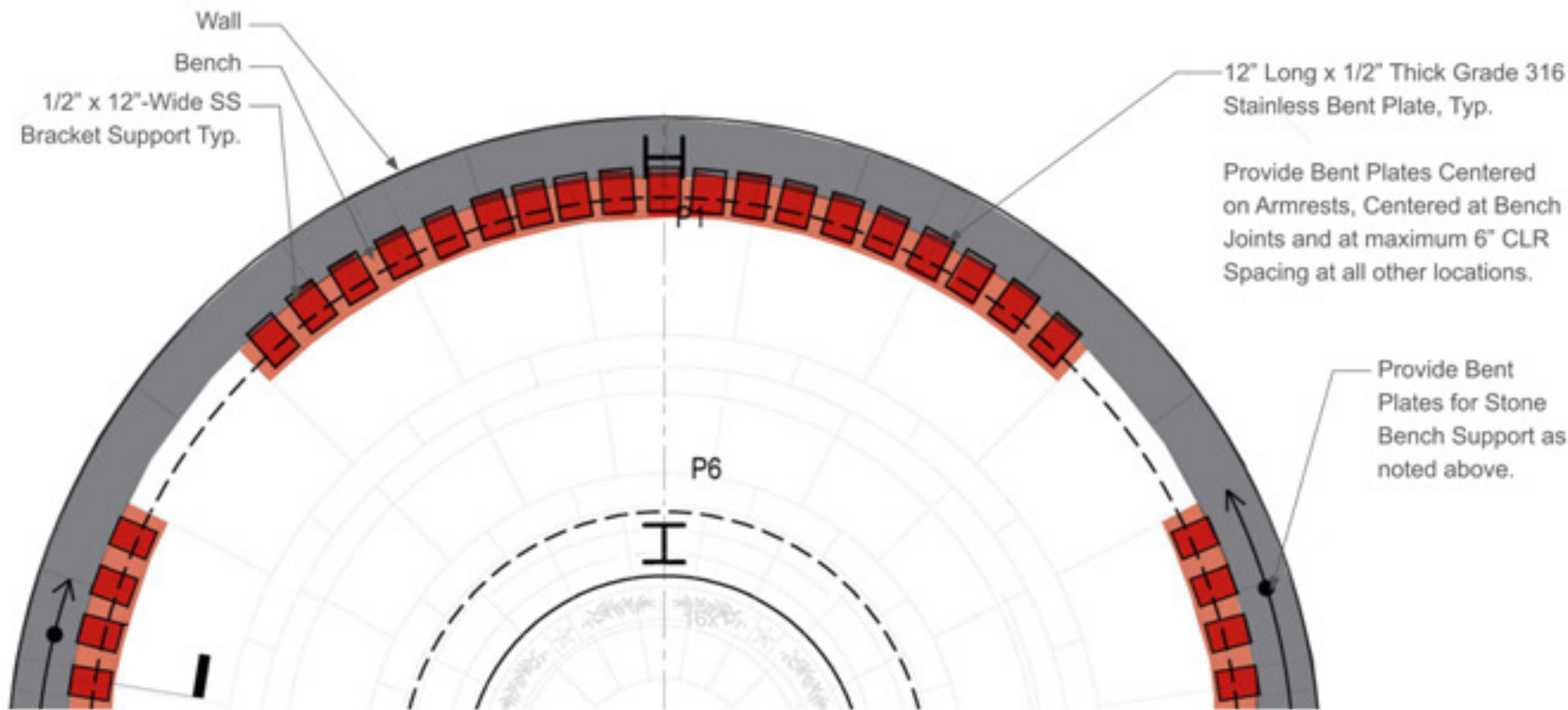

Enlarged Plan

scale: NTS

Detail - Bench Support

scale: NTS

II. Bench Armrest Design

- Bench armrests to be bronze
- Mounting stainless steel plate beneath bench, connected to concrete wall
- Armrest located between bench segments, at joint



Precedent: Existing Handrail at WWII Memorial
NTS

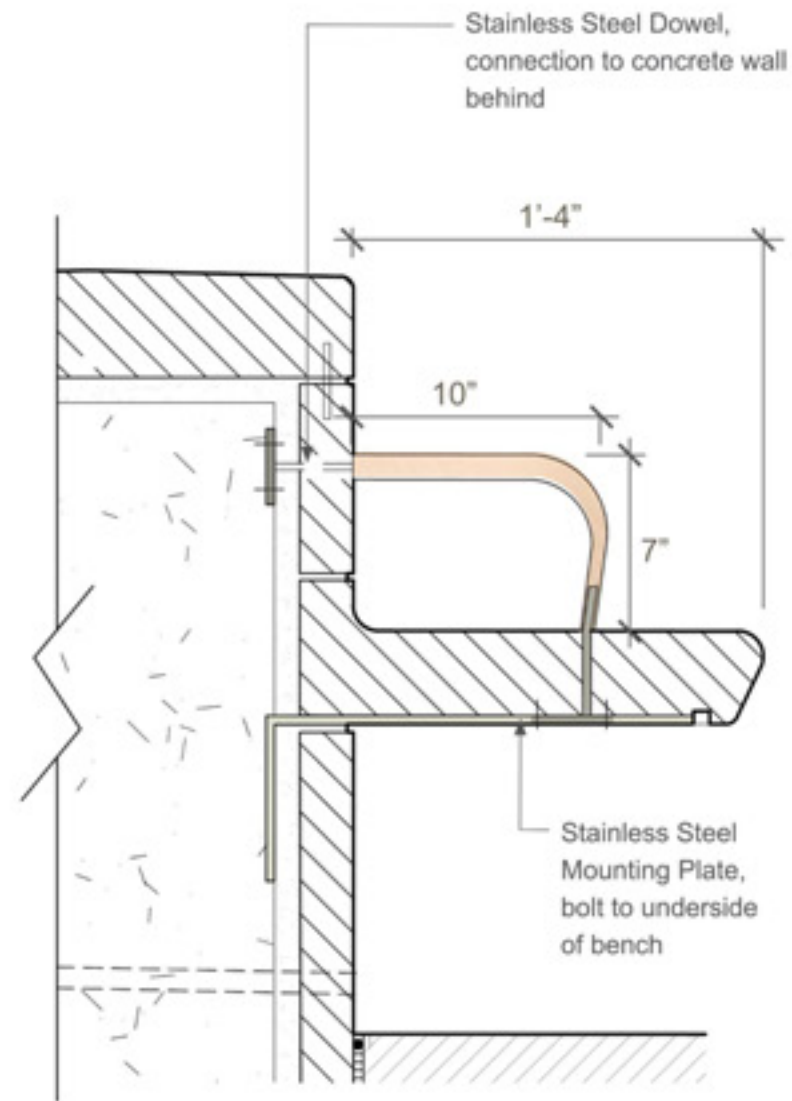

Bronze Armrest on Granite Bench - Section
scale: NTS

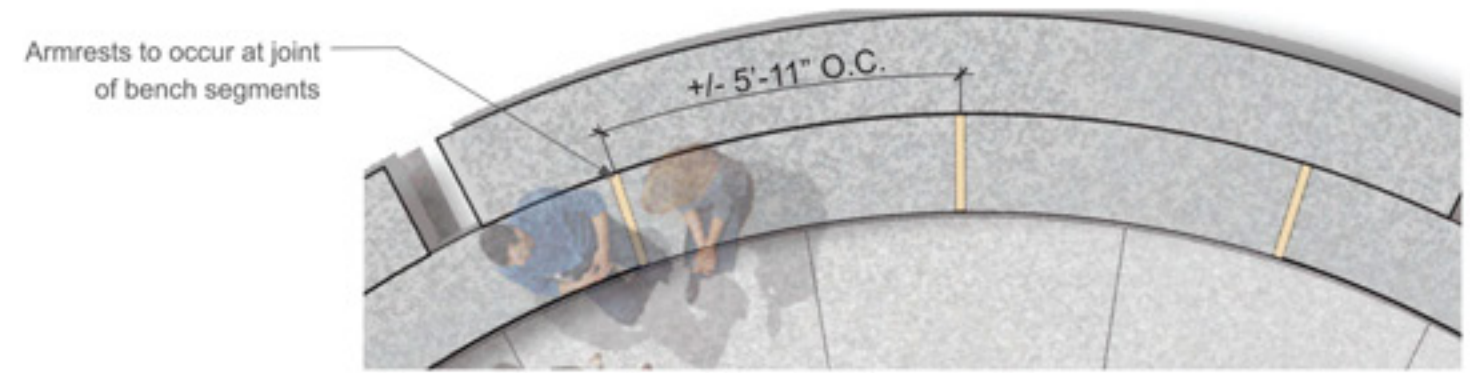

Bronze Armrest on Granite Bench - Plan

scale: NTS

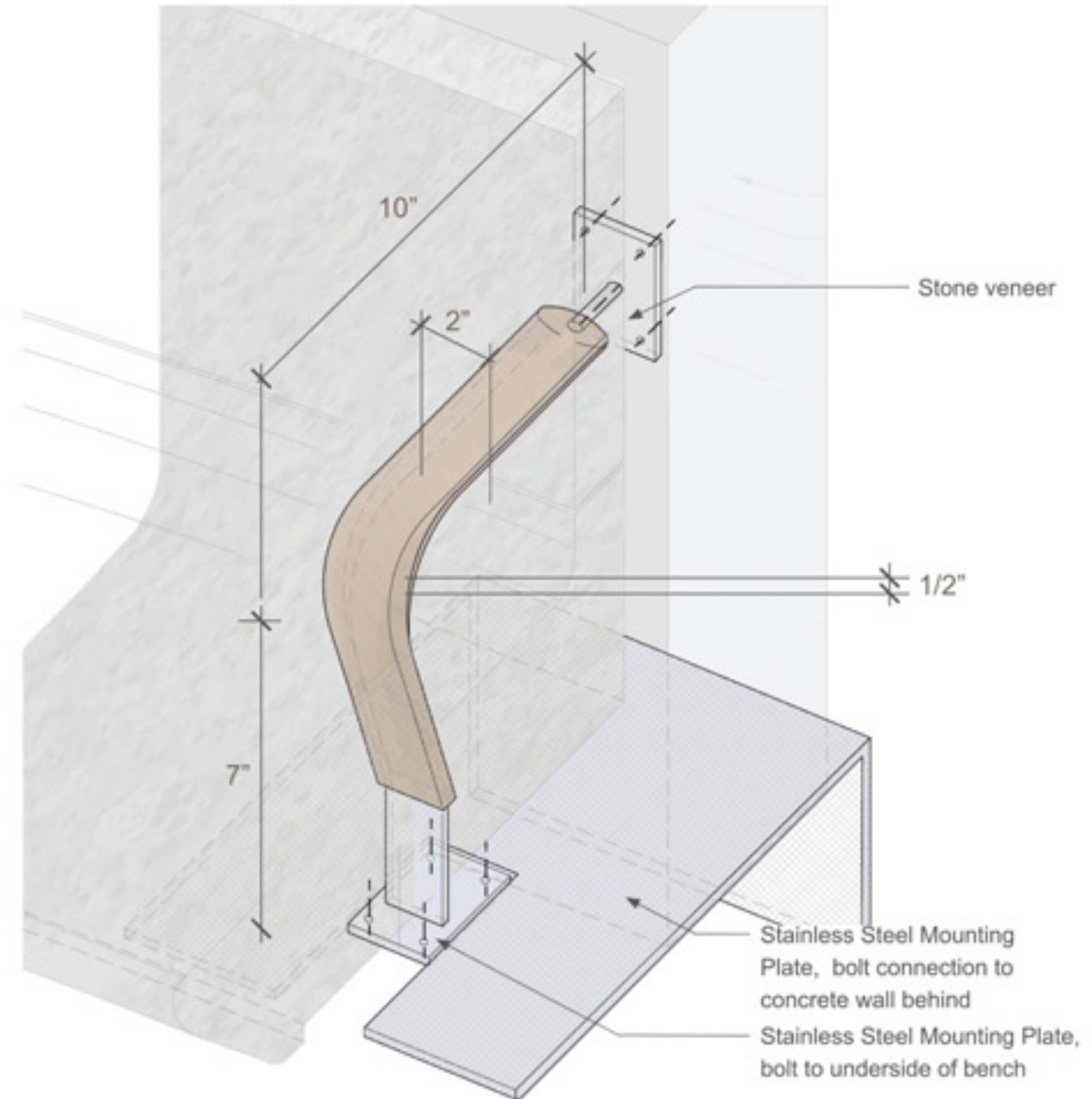

Bronze Armrest on Granite Bench - Axonometric

scale: NTS

III. Structural Support of Prayer Plaque

"...the Commission recommended that additional details be developed, [including], sufficient structural supports to prevent deformation of the **prayer plaque**..."

- Posts: 2-1/2" dia. x 1/4" thick SS hollow tube, welded to SS inbed plate in wall
- Spine: 3-1/2" x 2-1/2" SS hollow tube
- Lateral Supports: 2' x 2" x 1/4" SS plates
- Plaque supports shall be stainless steel and blackened to reduce visibility

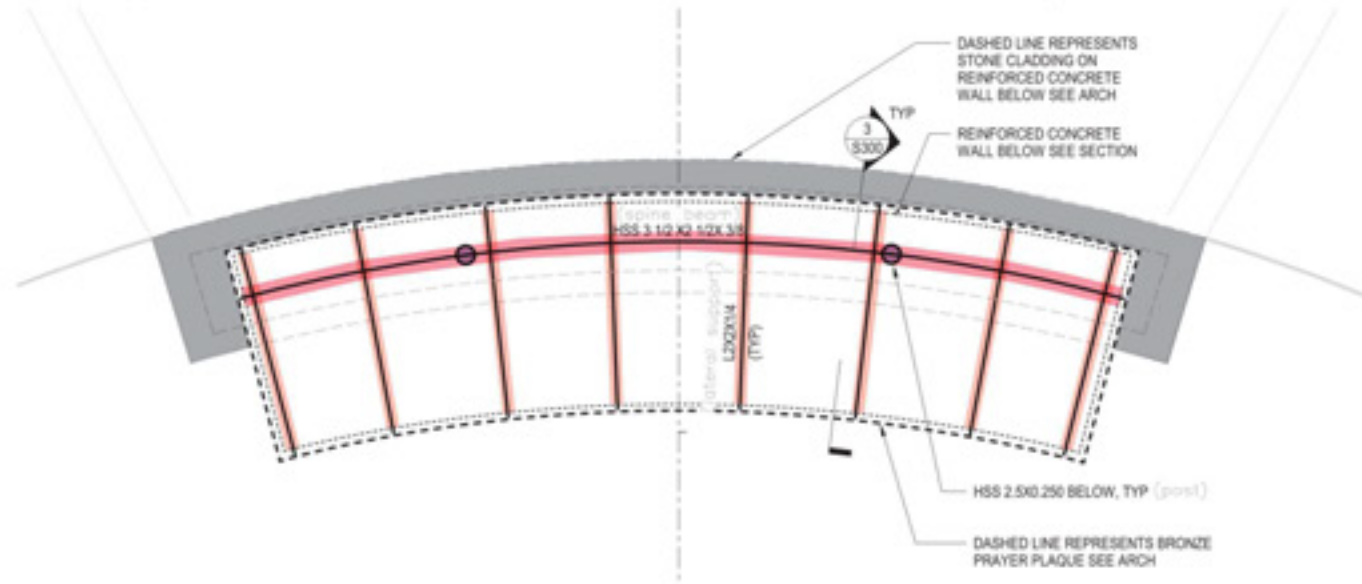

Plan

scale: NTS

SCALE: 1" = 1'-0"

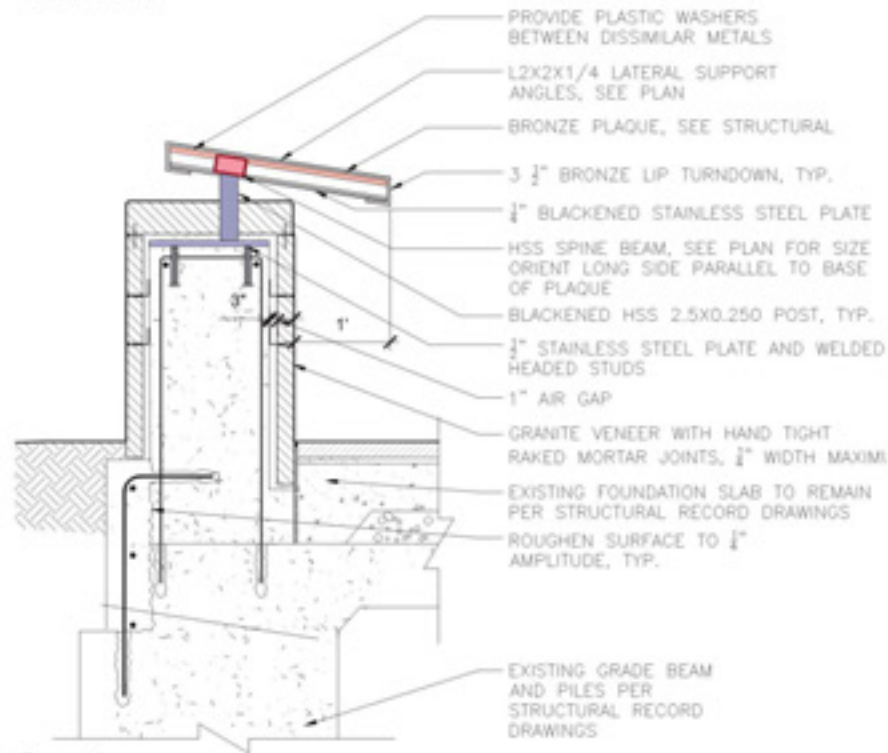

Section

scale: NTS



Blackened Steel Samples



Views

IV. Medallion and Garland Design

"...the Commission recommended that additional details be developed, [including], the design for the composition of the **medallion and garland** within the pavement..."

"In their discussion of the option for a bronze medallion at the center, intended to repeat the Victory Medal design in the arches of the World War II Memorial, some Commission members raised concern that the figural composition would create an undesirable directionality to the space and would detract from the importance of the prayer plaque, while others found that the medallion as proposed has strong symbolic importance and reinforces the connection to the main part of the memorial; the Commission concluded by recommending a design featuring both the garland and the medallion." *CFA Letter May 27, 2021*

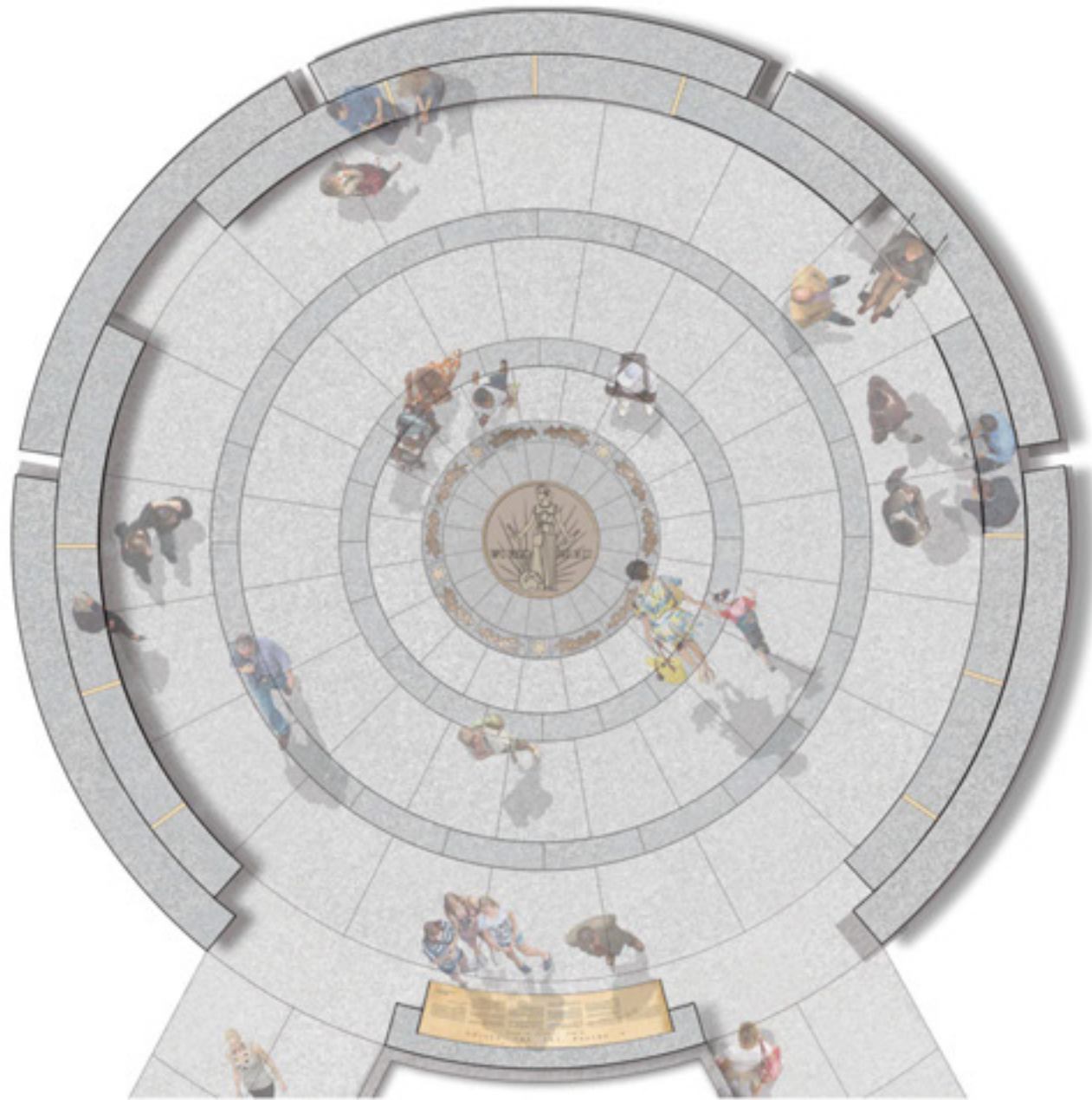

Plan (as previously reviewed)

scale: NTS

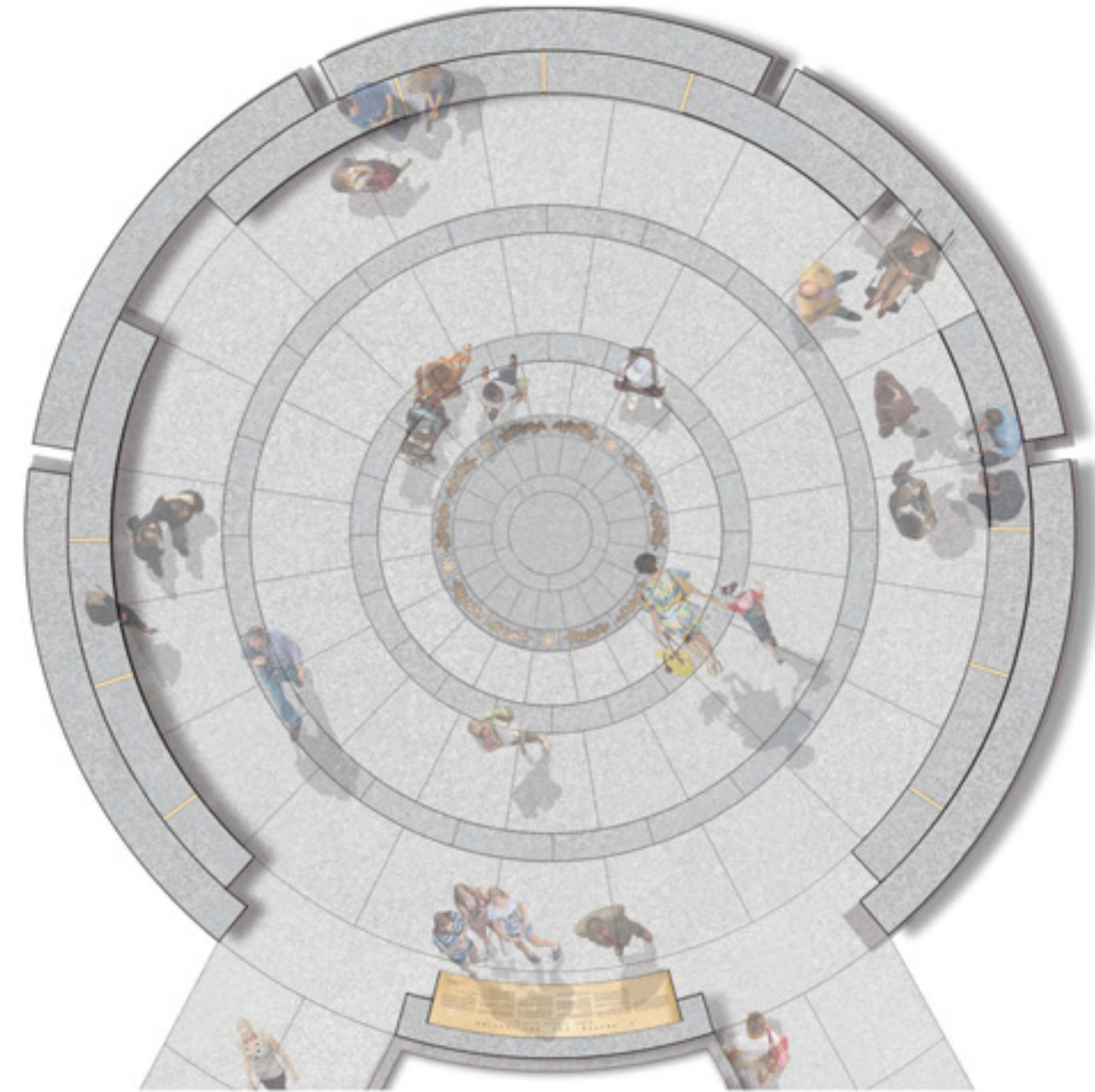

Plan (current)

scale: NTS

IV. Medallion and Garland Design

"...the Commission recommended that additional details be developed, [including], the design for the composition of the **medallion and garland** within the pavement..."

"Concerning the options presented for the center of the pavement within the circle, the Commission members unanimously endorsed the inclusion of the circular garland design of olive branches and five stars, suggesting that this element could be made bolder, possibly larger or located in an inner ring of the pavement; to enhance the clarity of this design, they recommended that the elements of the garland be bronze inset into the granite paving stones instead of cast as bronze panels." *CFA Letter May 27, 2021*



Plan (enlarged garland and star)

scale: NTS



Plan (enlarged garland center)

scale: NTS

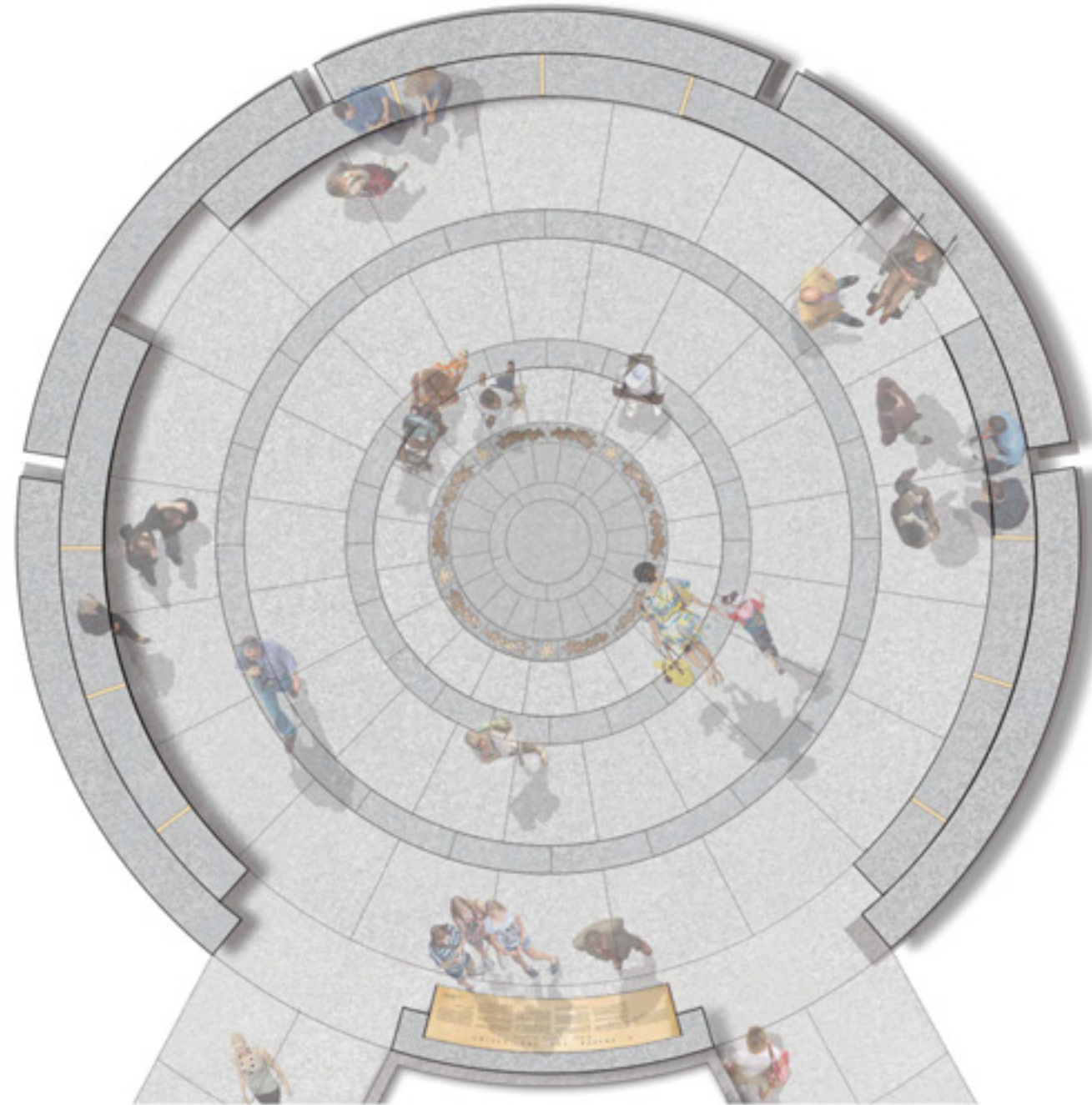

Plan (current)

scale: NTS

IV. Medallion and Garland Design

"...the Commission recommended that additional details be developed, [including], the design for the composition of the **medallion and garland** within the pavement..."

- Bronze stars and olive branches to be inset in granite paving band
- Olive garland is botanically inspired, rather than stylized

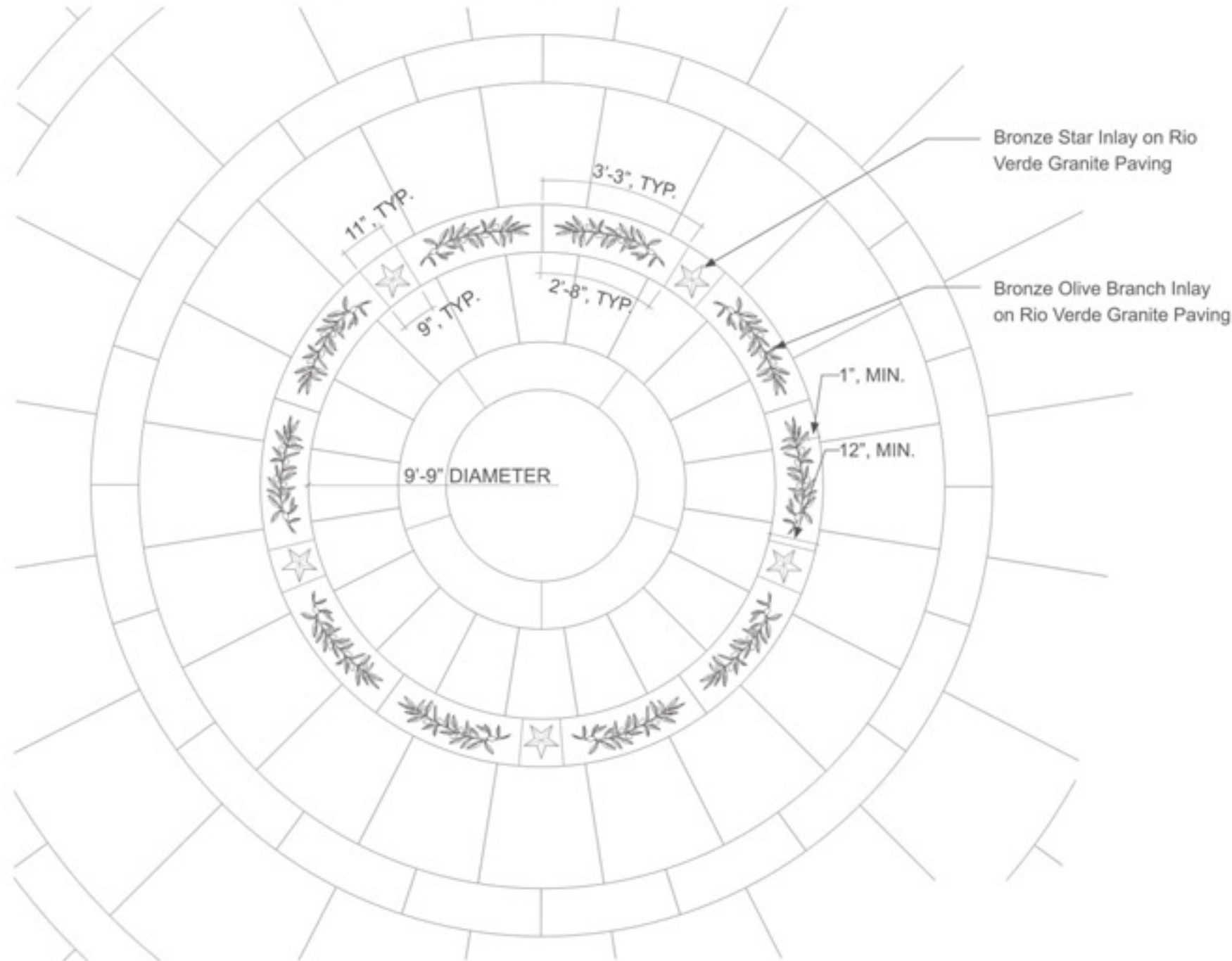

Plan
scale: NTS

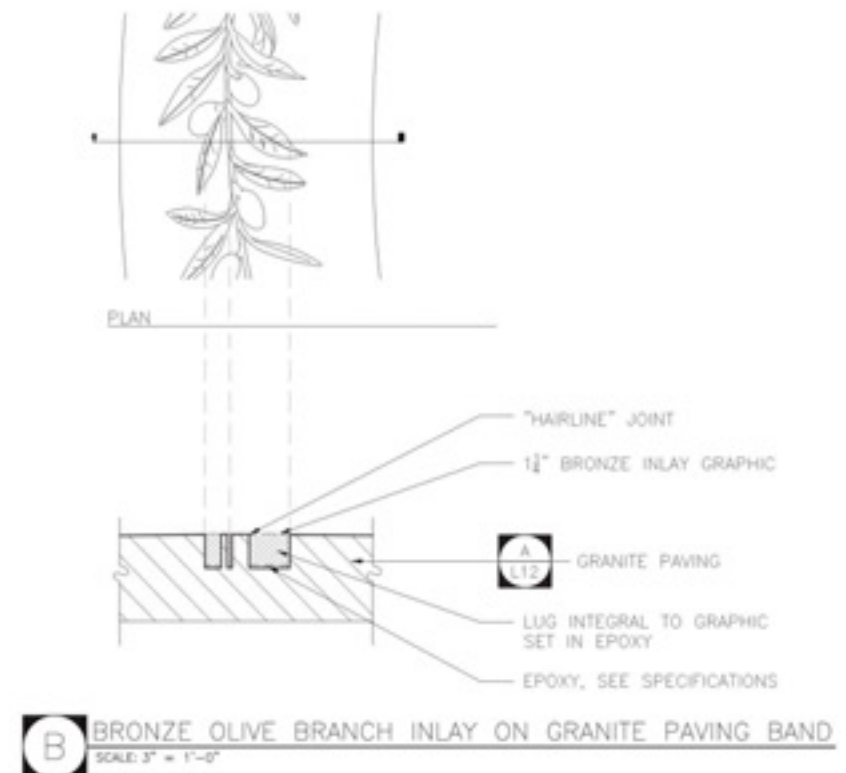
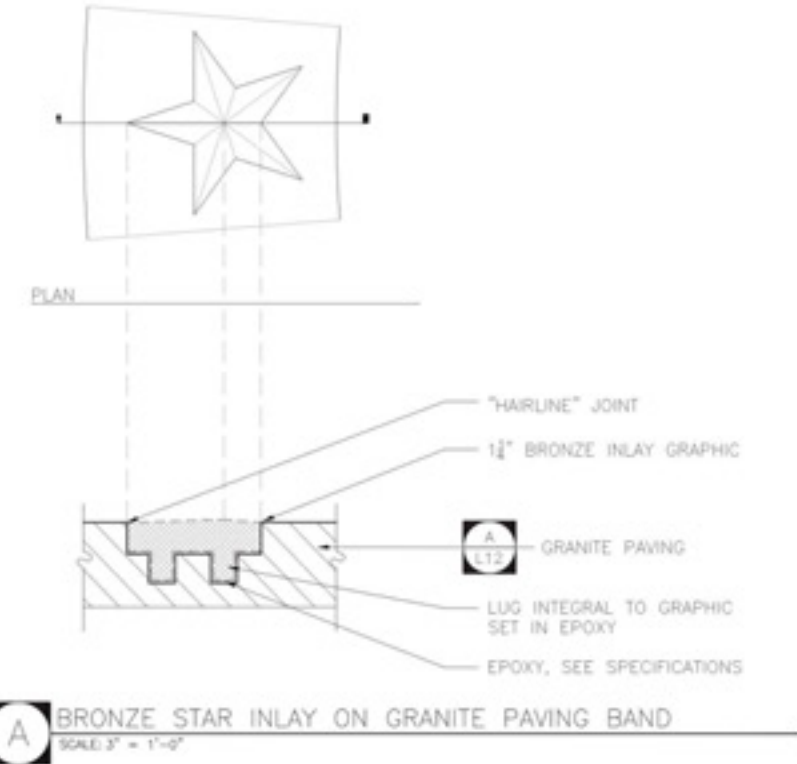

V. FDR Prayer Plaque and Inscriptions

“...the Commission recommended that additional details be developed, [including], the layout of the proposed graphic design for the plaque and **inscriptions.**”

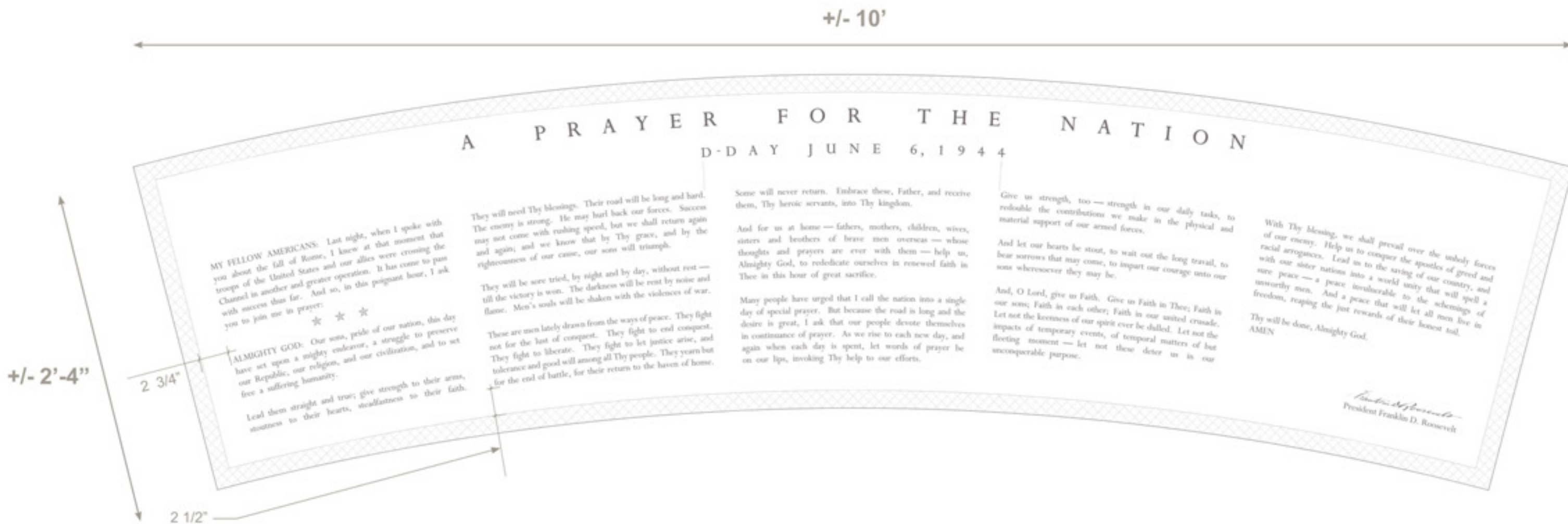

Plan (as previously reviewed and approved)

scale: NTS

V. FDR Prayer Plaque and Inscriptions

"...the Commission recommended that additional details be developed, [including], the layout of the proposed graphic design for the plaque and **inscriptions.**"

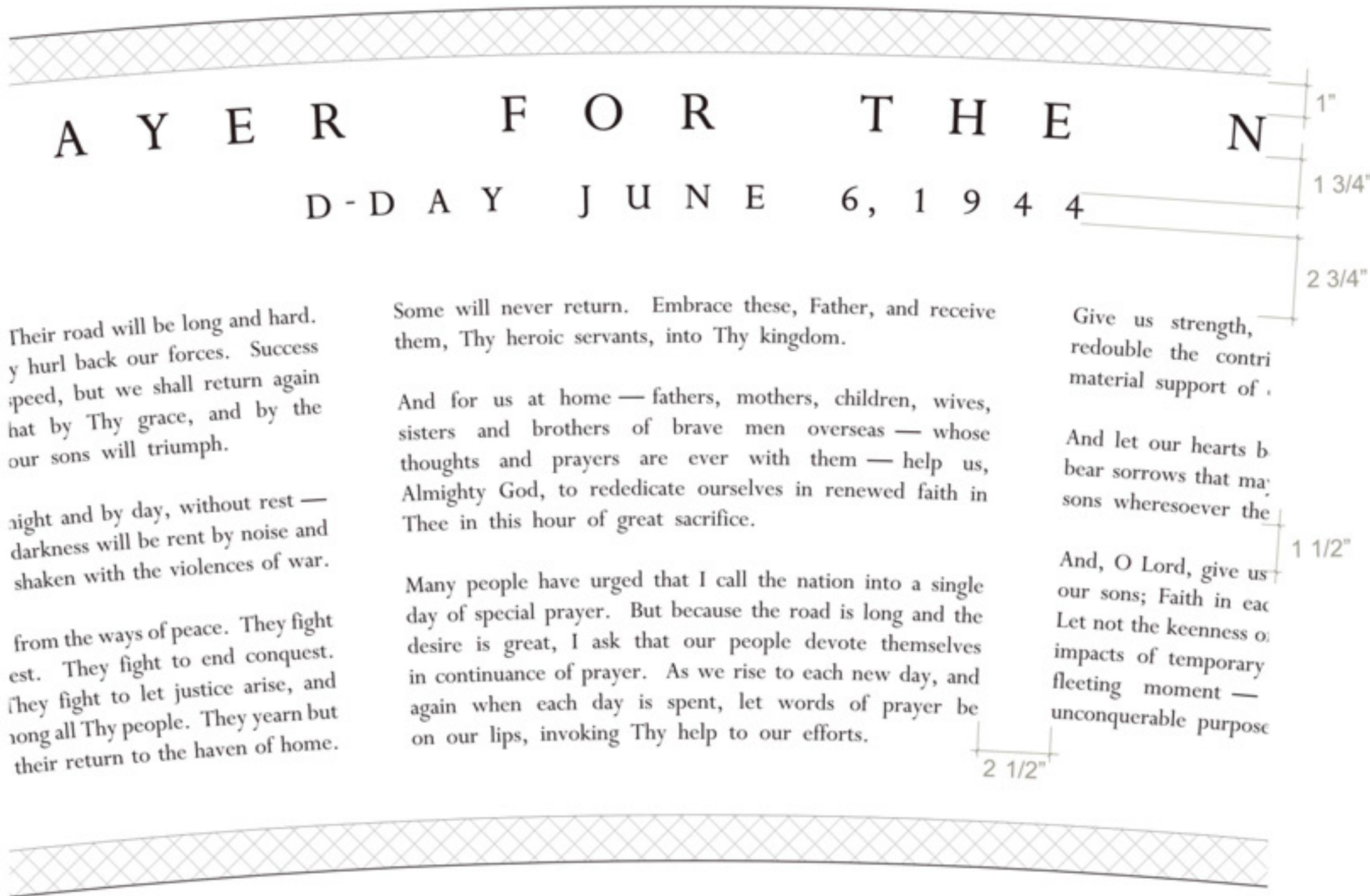

Font for Front Wall and Plaque:
Perpetua

A PRAYER

Font Parameters (Bronze Plaque)

- Complementary to Roman Claudian Variant
- Meets ADA Accessibility Guidelines (ADAAG)
- Meets parameters for casting:
 - Heading
 - 1-1/2 inch
 - Subheading
 - 1 inch
 - Body Text
 - 3/8 inch is minimum text height visible from three feet
 - 25 point kerning (space between letters)
 - 2 pts thick minimum stroke

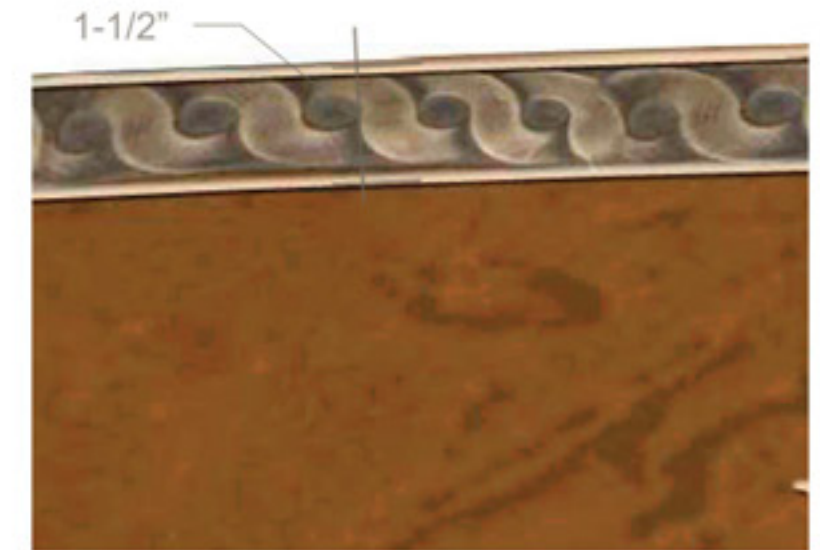

Guilloche Border Detail

actual size

Plaque Text Layout

scale: NTS

V. FDR Prayer Plaque and Inscriptions

"...the Commission recommended that additional details be developed, [including], the layout of the proposed graphic design for the plaque and **inscriptions.**"

Font for Front Wall and Plaque:
Perpetua

A PRAYER



Entry Text Layout Elevation

scale: NTS

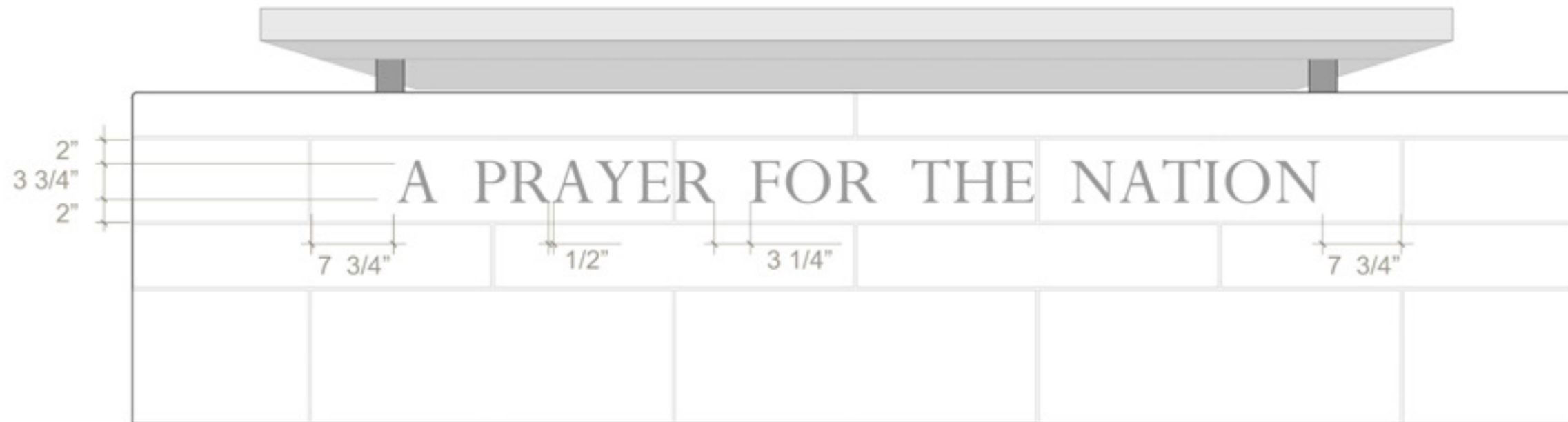

Entry Text Layout View

scale: NTS

VI. Wall Coursing (ends)

- Wall incorporates (3) stone bands, with center band corresponding to bench
- Bench profile draws from simplified WWII bench design
- Armrests centered on stone veneer

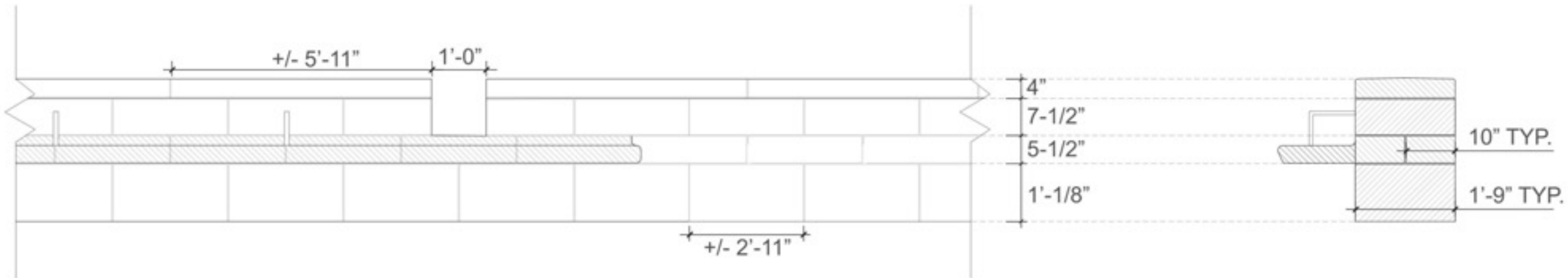

Wall Coursing: Interior Elevation

scale: NTS

Wall Coursing: End Profile

scale: NTS

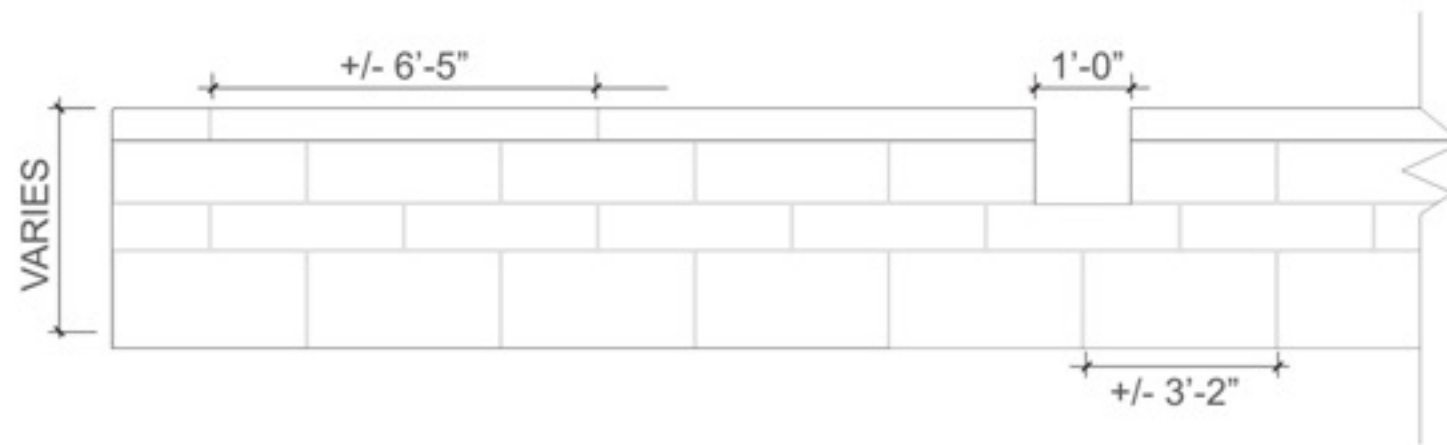

Wall Coursing: Exterior Elevation

scale: NTS



Wall Coursing: End Profile View

scale: NTS

MATERIALS INDEX

GRANITE

- ① 'Greene County' granite (primary paving)
- ② 'Moss Green' granite (paving accent)
- ③ 'Kershaw' granite (wall and bench)

BRONZE

- ① Ornamental Bronze Inlay (stars & garland)
- ② Bronze Armrests (atop perimeter benches)
- ③ Bronze Stars and Olive Garland

