



# ENGINE COMPANY 7

## CFA PACKAGE - CONCEPT REVIEW

1101 HALF STREET SW, WASHINGTON D.C.

20 NOVEMBER 2025



fgma

STUDIO



## PROJECT LOCATION

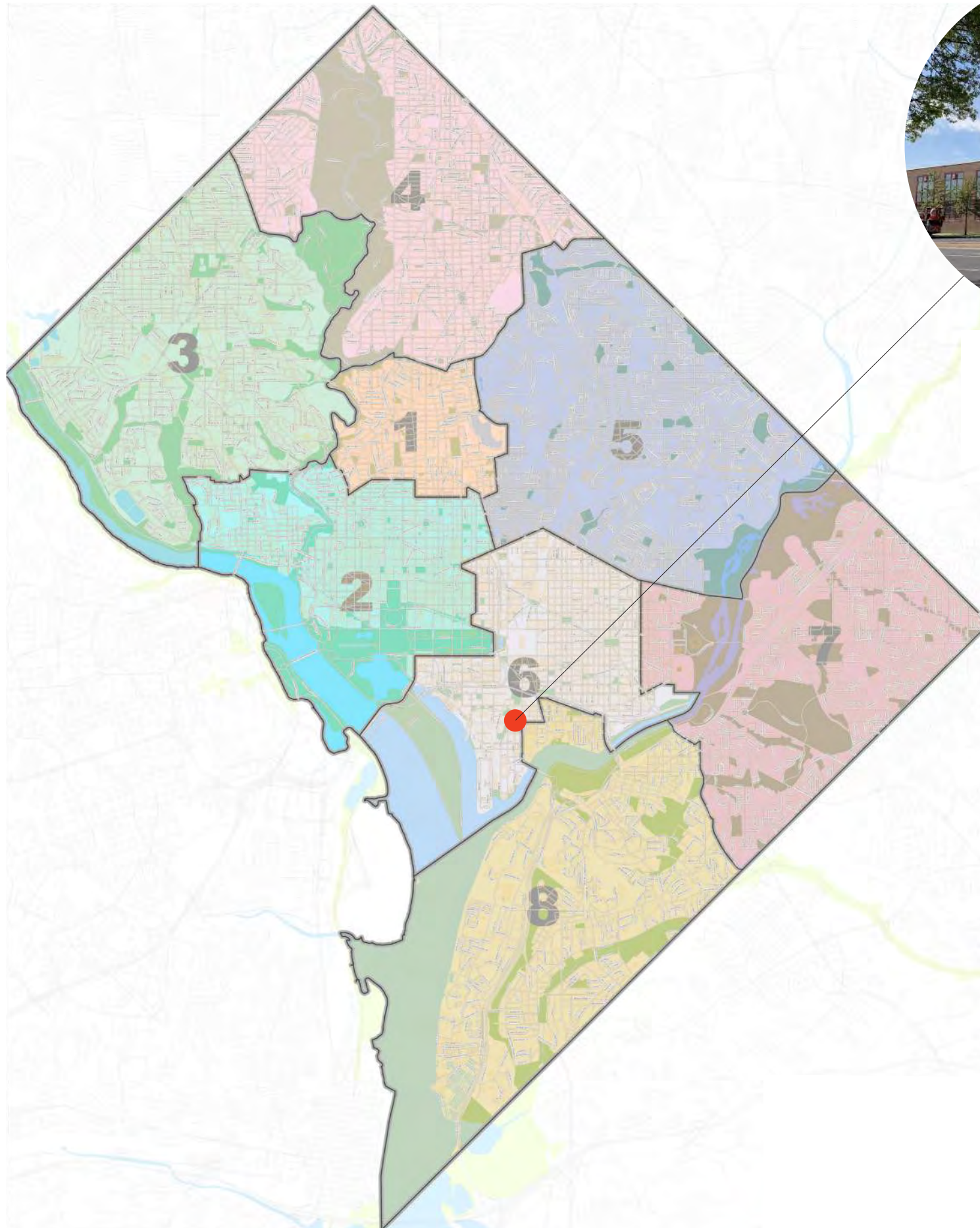

ENGINE CO NO 7



fgma







AERIAL VIEW | NAVY YARD









1 | EXISTING FIRST FLOOR PLAN

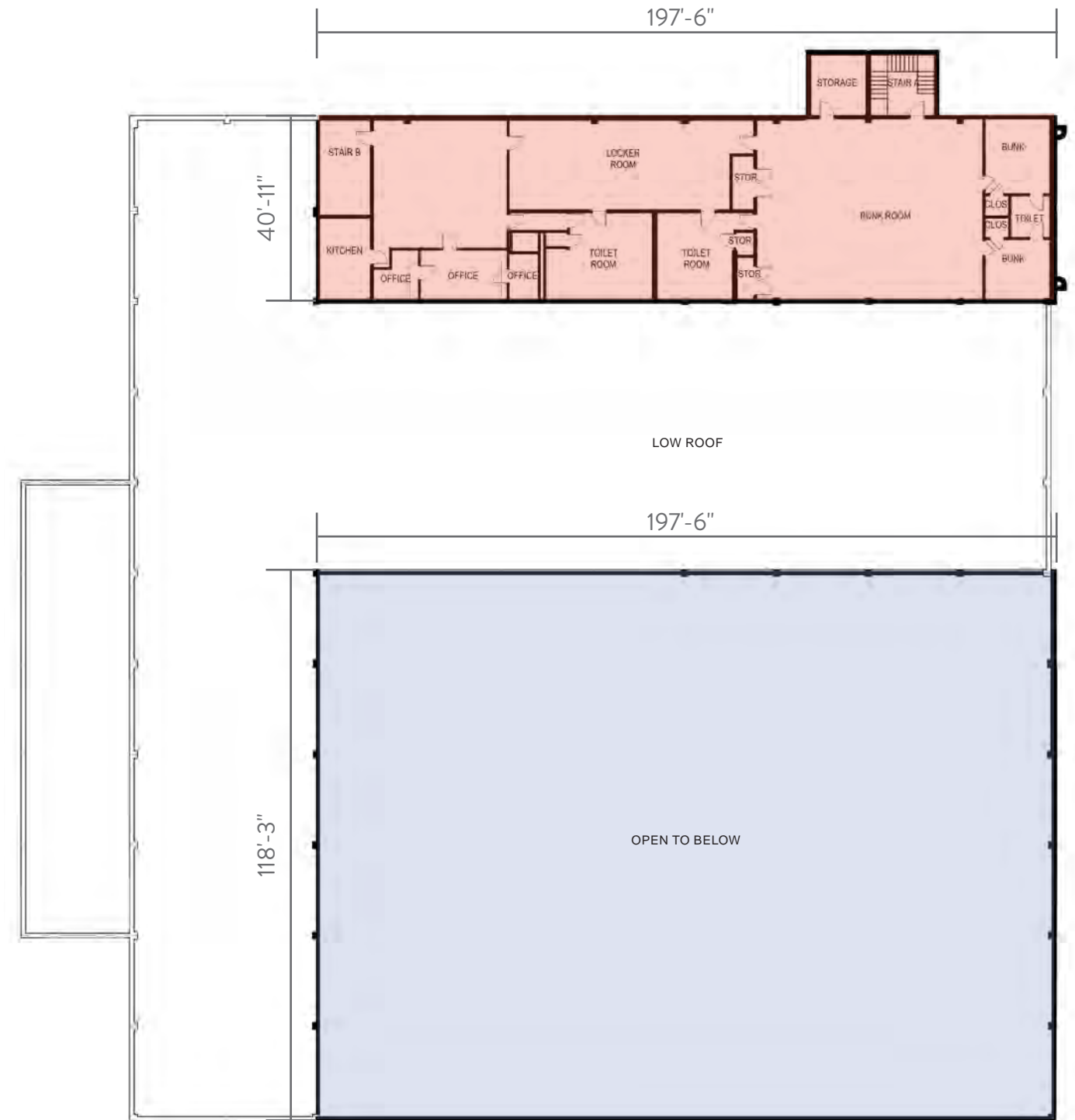

2 | EXISTING SECOND FLOOR PLAN

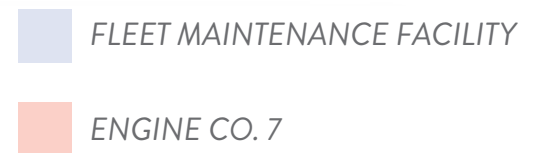

## EXISTING DOCUMENTATION | PLANS



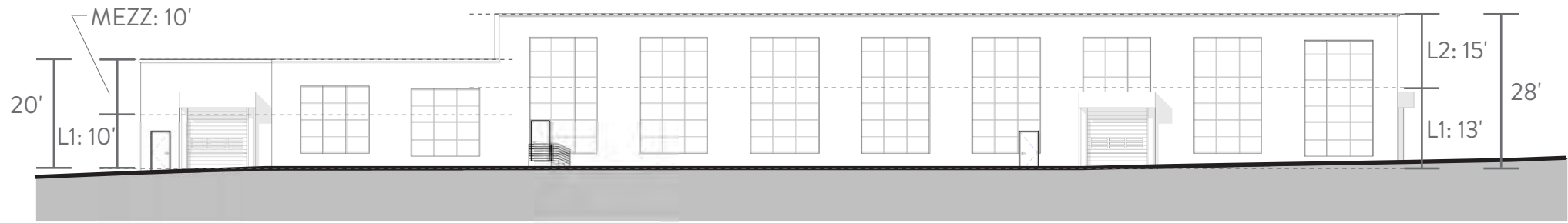

1/ SOUTH ELEVATION

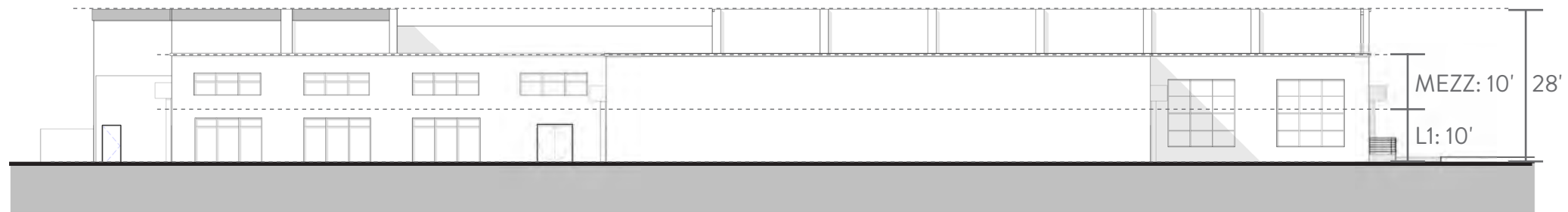

2/ WEST ELEVATION



3/ NORTH ELEVATION

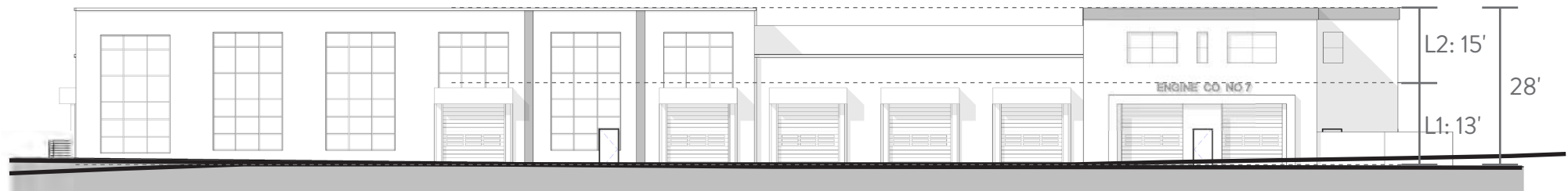

4/ EAST ELEVATION\*

\*DRAWINGS ARE NOT TO SCALE



## EXISTING DOCUMENTATION | ELEVATIONS

ENGINE COMPANY 7  
CFA PACKAGE | 6



fgma





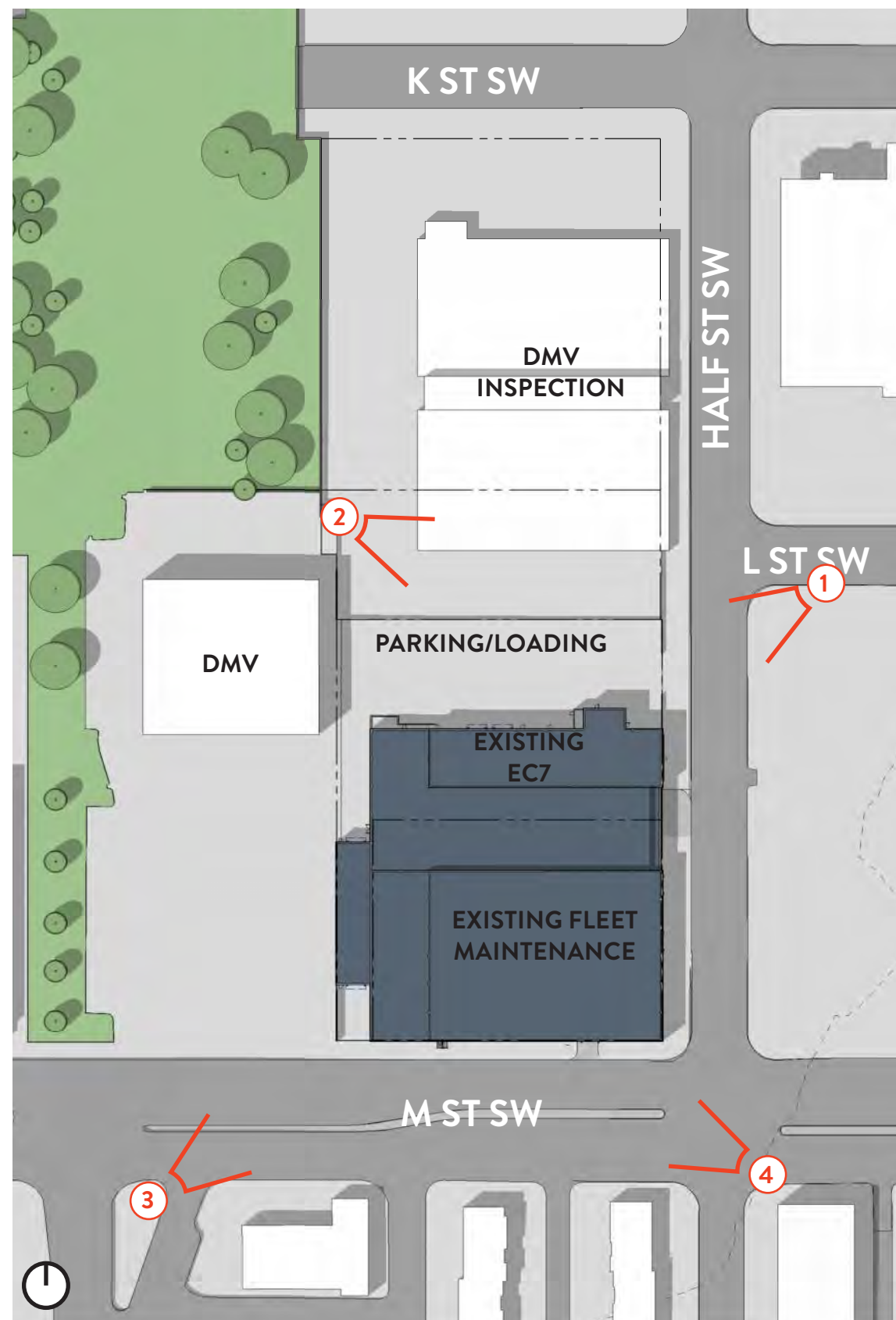

1 | PRIMARY ENTRANCE



2 | NORTH FACADE OF EXISTING EC7



3 | SOUTHWEST VIEW FROM M ST



4 | SOUTH FACADE OF EXISTING EC7

## VIEWS TOWARDS THE SITE



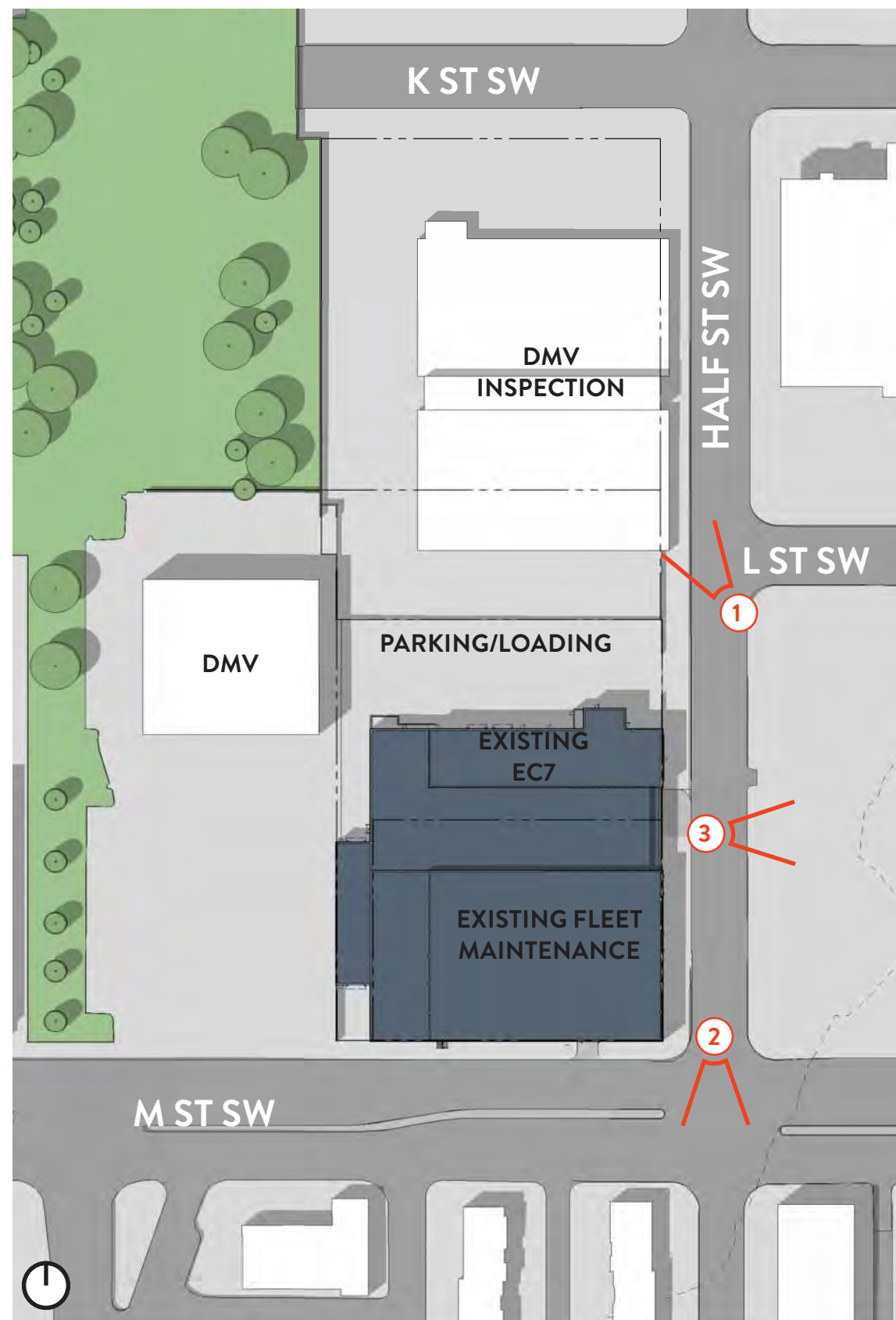

## VIEWS FROM THE SITE



1 | DMV INSPECTION'S EAST FACADE (FACING NORTH)



2 | M STREET SW INTERSECTION (FACING SOUTH)



3 | HALF STREET PUBLIC PARKING LOT (FACING EAST)





## VIEWS TOWARDS ADJACENT GREENERY



1. | EXISTING PARKING ENTRANCE (FACING NORTHWEST)



2. | NORTHWEST GREEN SPACE (FACING SOUTHEAST)



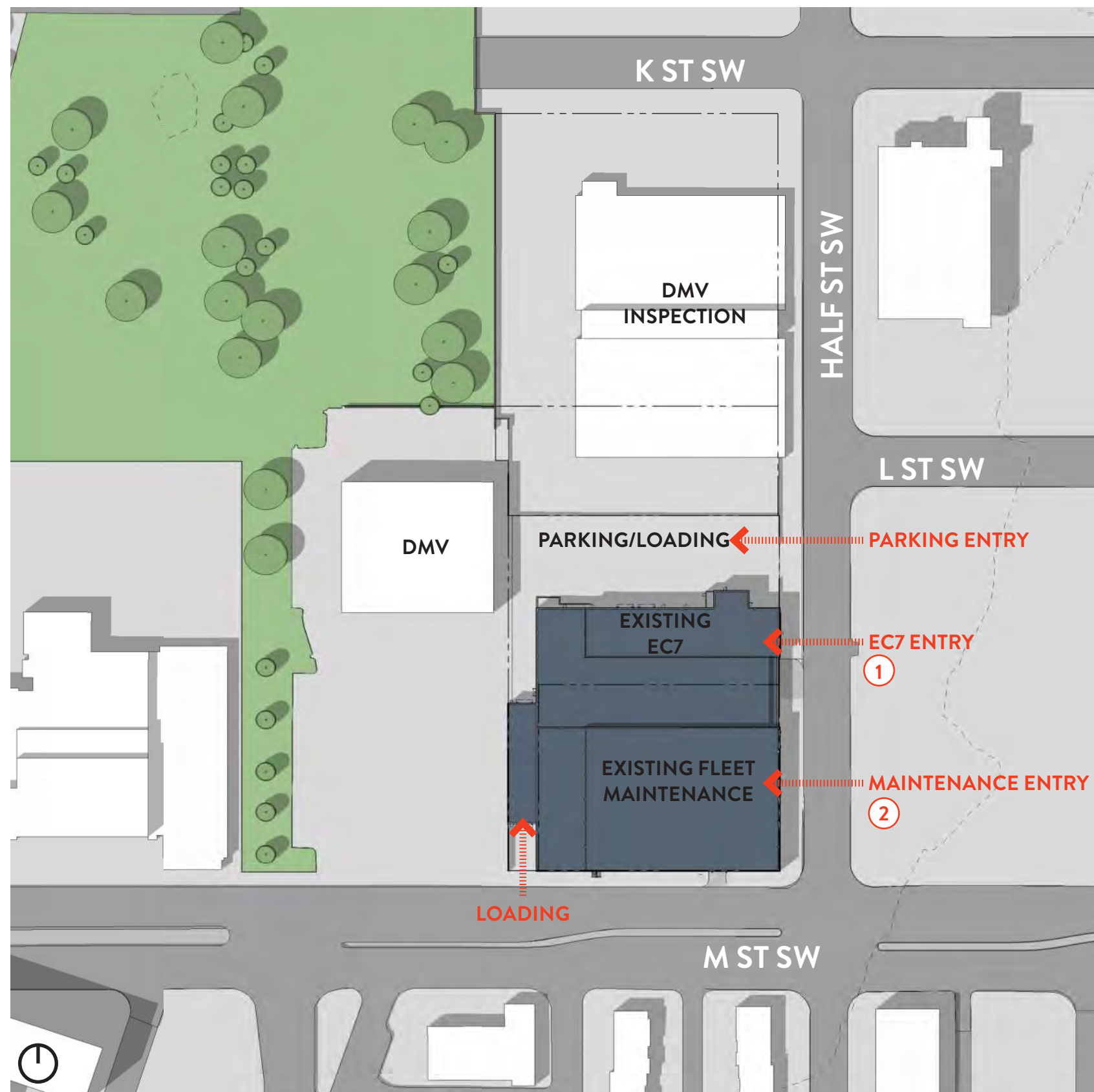

## EXISTING ENTRANCES



1/ PRIMARY ENTRANCE (FROM HALF STREET)



2/ FLEET MAINTENANCE ENTRANCE (FROM M STREET)





## SITE ANALYSIS | NEIGHBORHOOD & STREETS

ENGINE COMPANY 7  
CFA PACKAGE | 11



fgma







## SITE ANALYSIS | NEARBY GREEN SPACES

ENGINE COMPANY 7  
CFA PACKAGE | 12





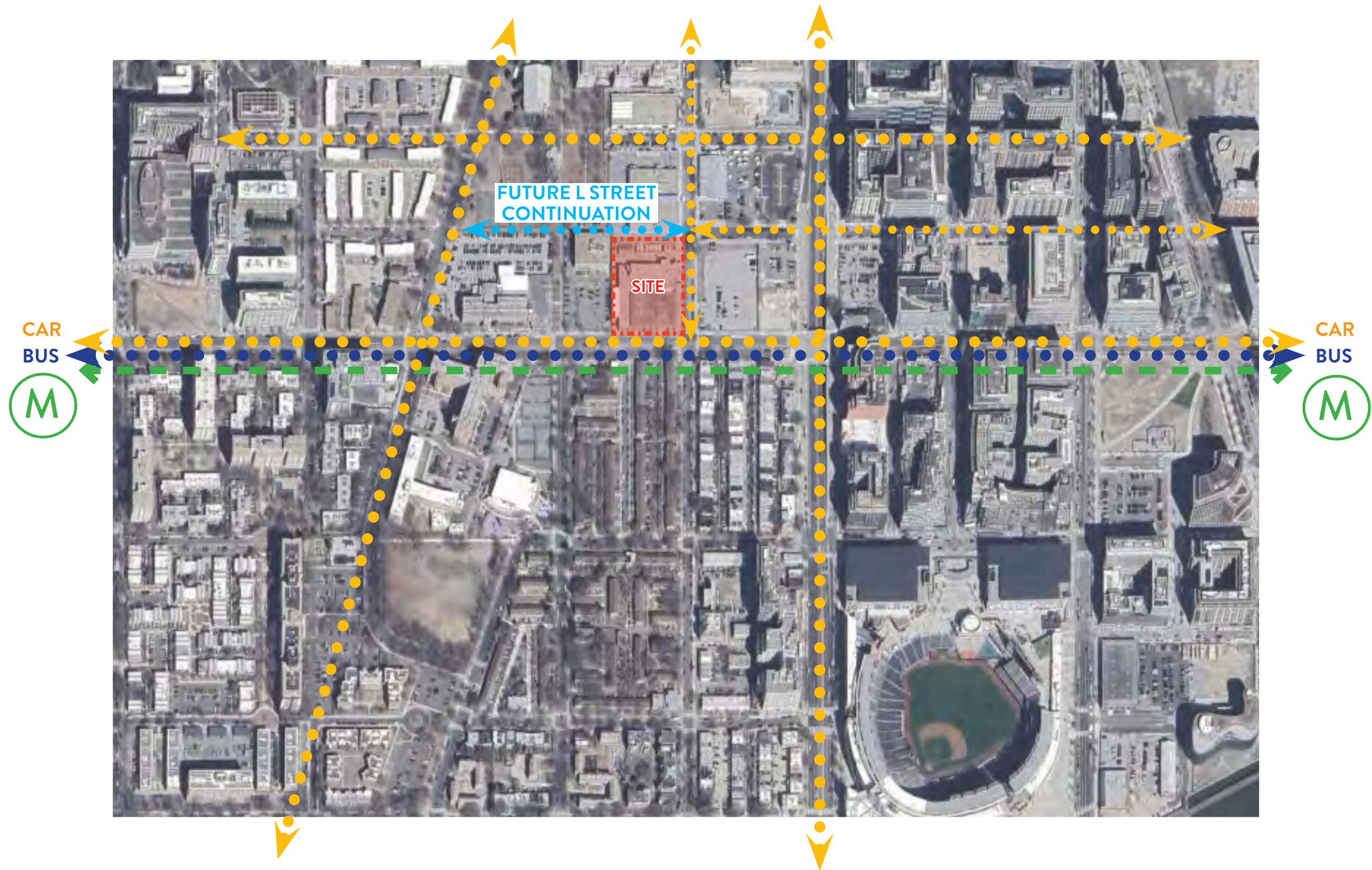

# SITE ANALYSIS | NETWORK OF STREETS AND ACCESS







ENGINE CO. 16



TRINIDAD FIREHOUSE



ENGINE CO. 17



ENGINE CO. 7 (EXISTING)



ENGINE CO. 1

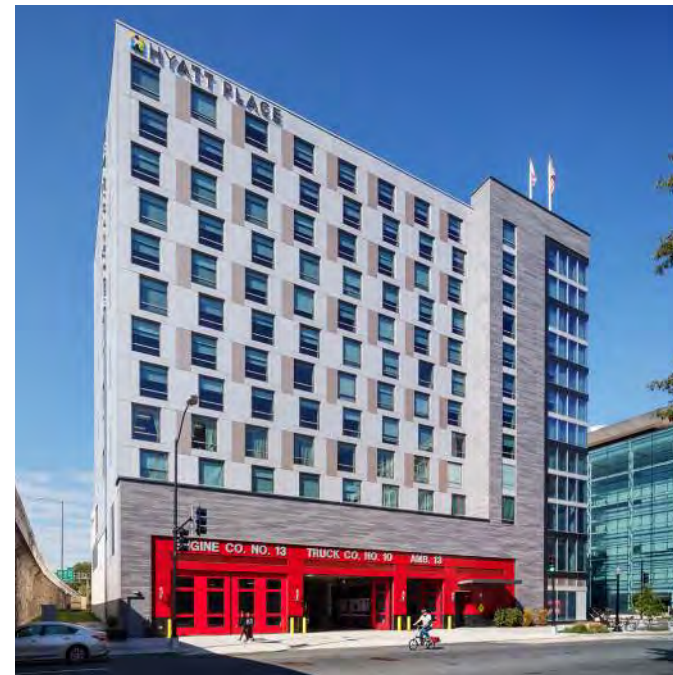

ENGINE CO. 13



ENGINE CO. 22



ENGINE CO. 14

## PRECEDENTS | DC FIRE STATIONS



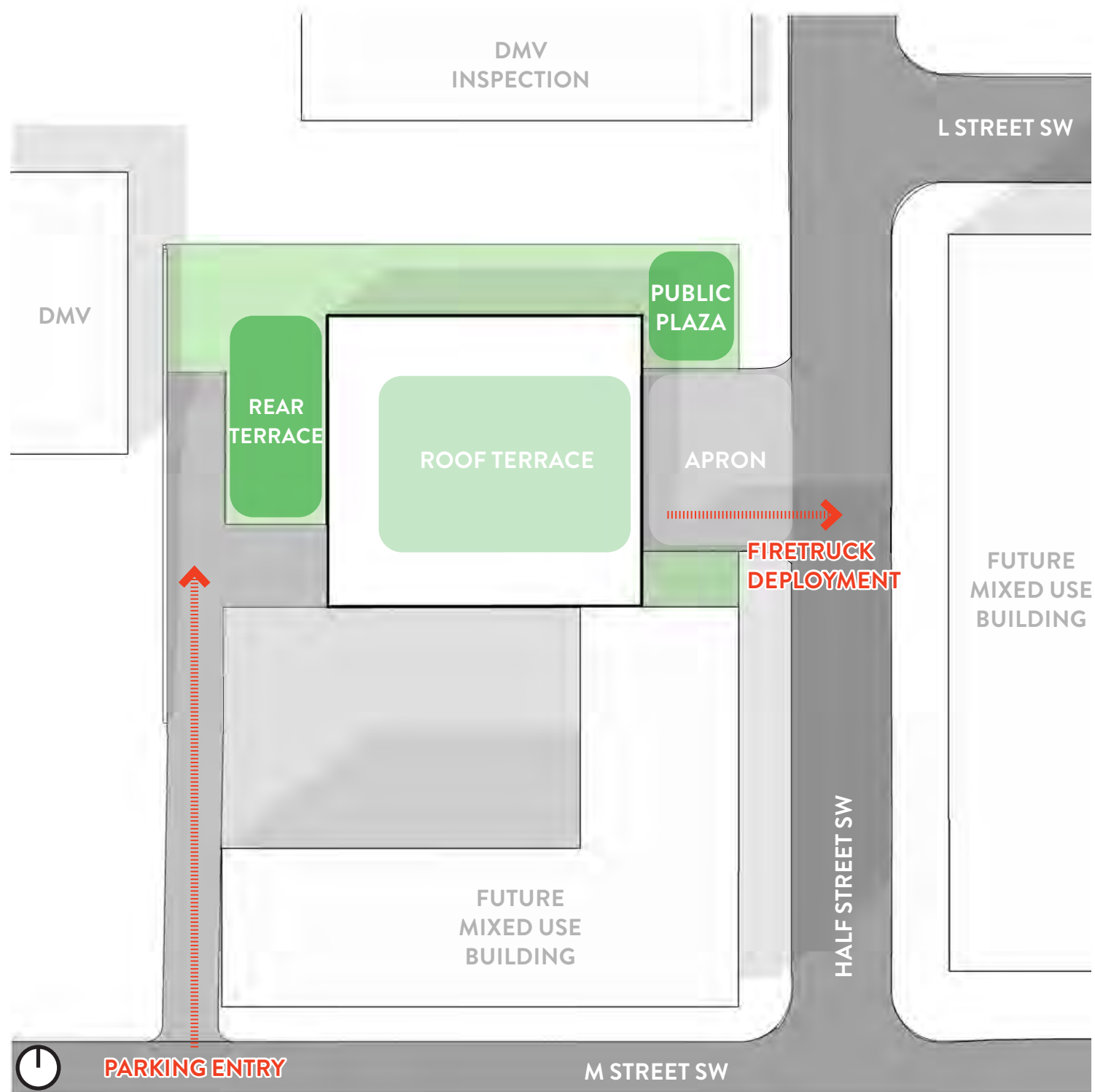

### ADMINISTRATION



### OPERATIONS



### SUPPORT

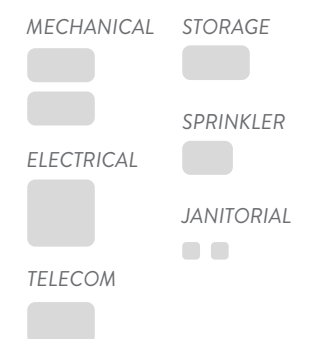

### LIVING



### DORMITORY

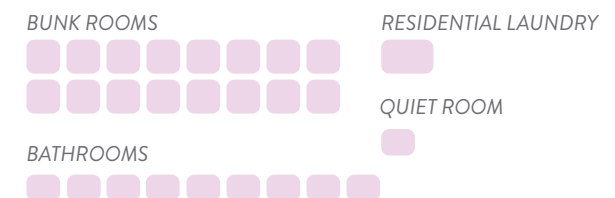

## EC 7 | PROGRAM REQUIREMENTS



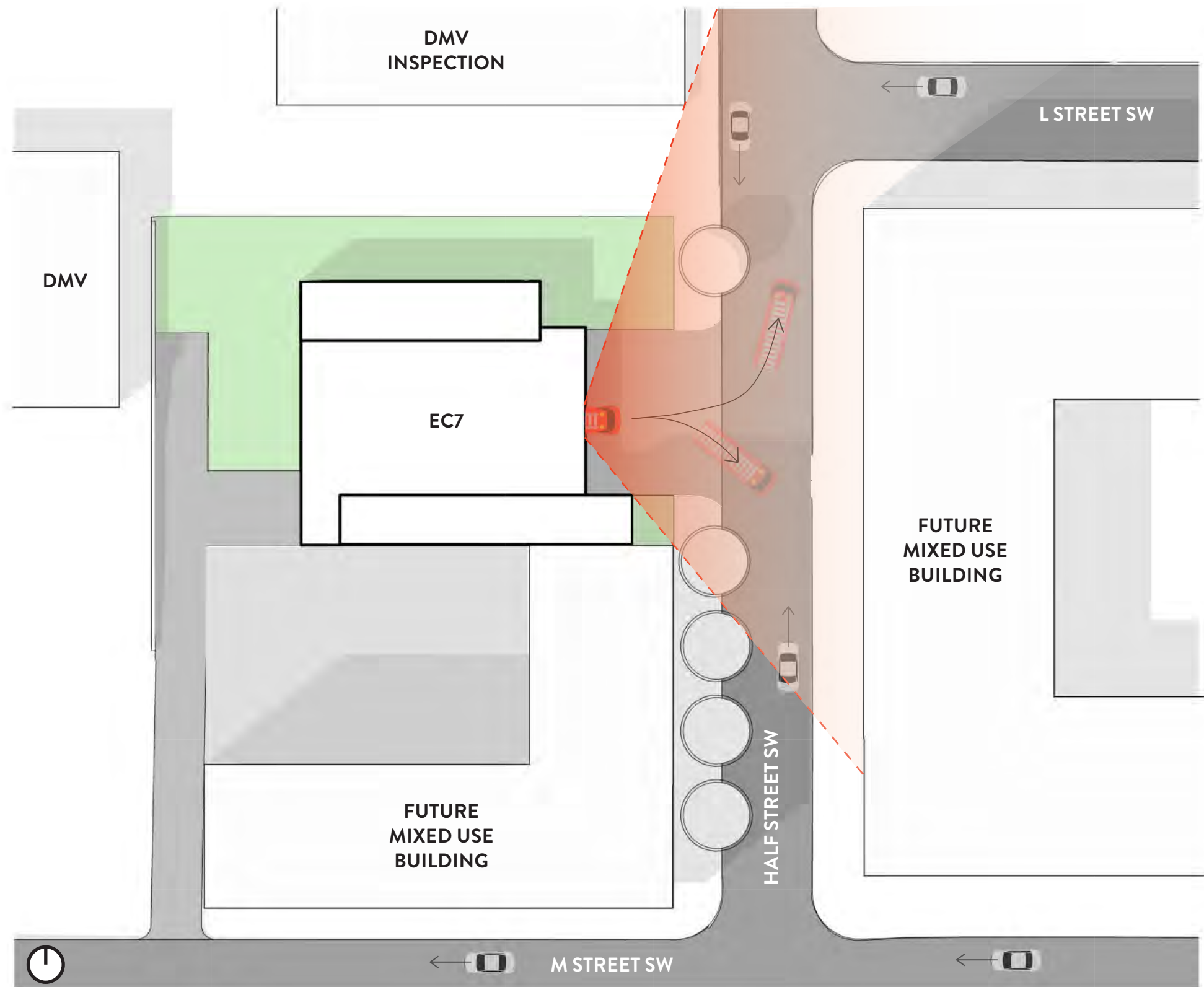

## EC7 | DEPLOYMENT DIAGRAM



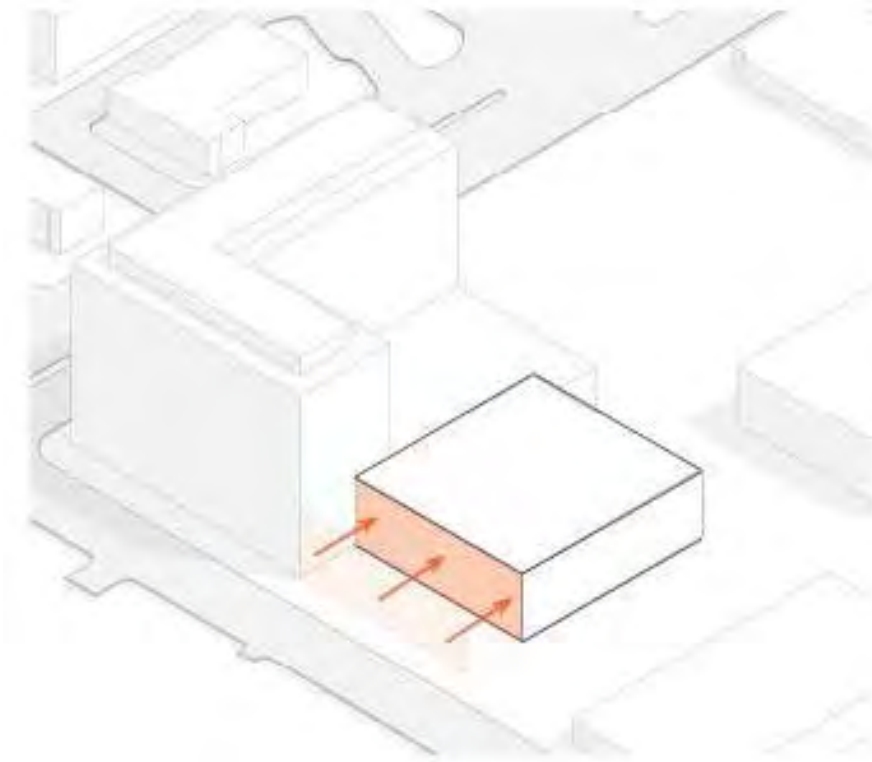

1 | STEP 1 - SETBACK BUILDING MASS FOR 50' APRON

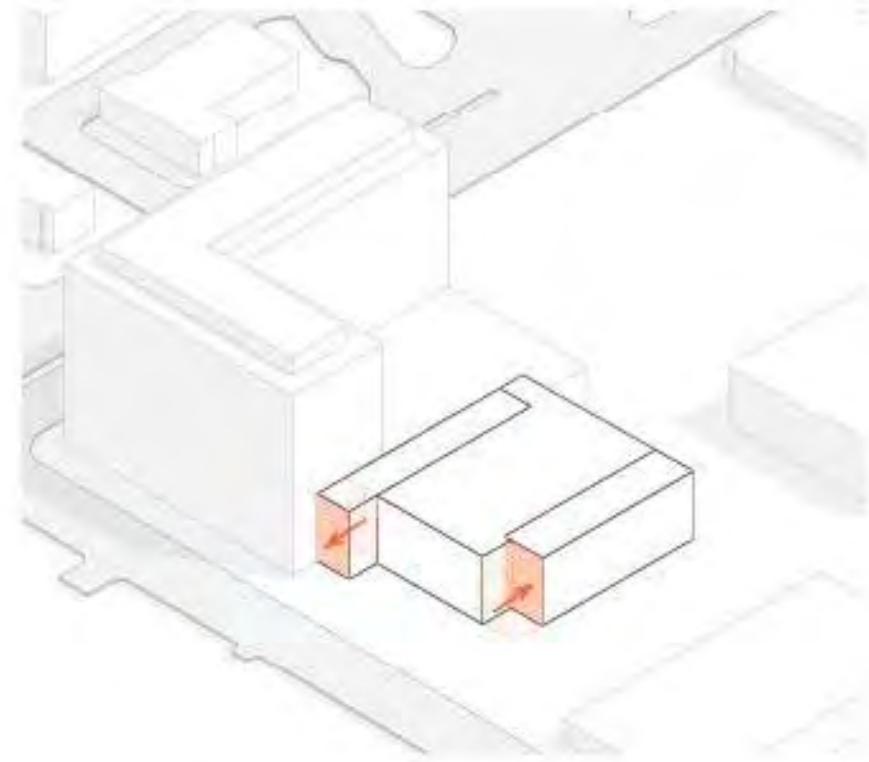

2 | STEP 2 - ESTABLISH WINGS FOR FIELD OF VISION DURING DEPLOYMENT

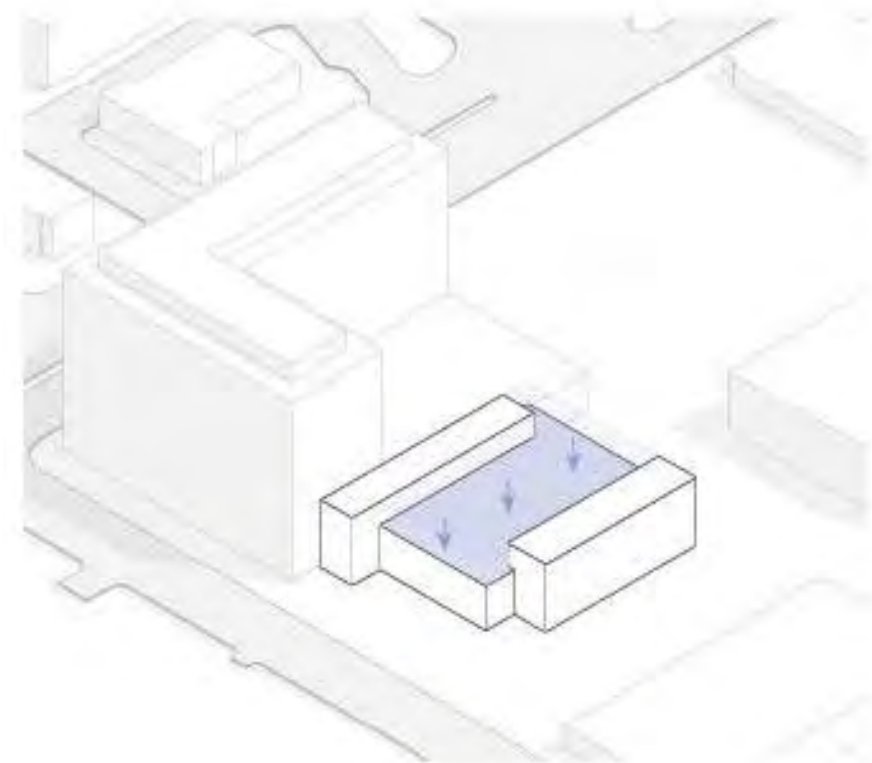

3 | STEP 3 - INSET ROOF TERRACE BETWEEN WINGS

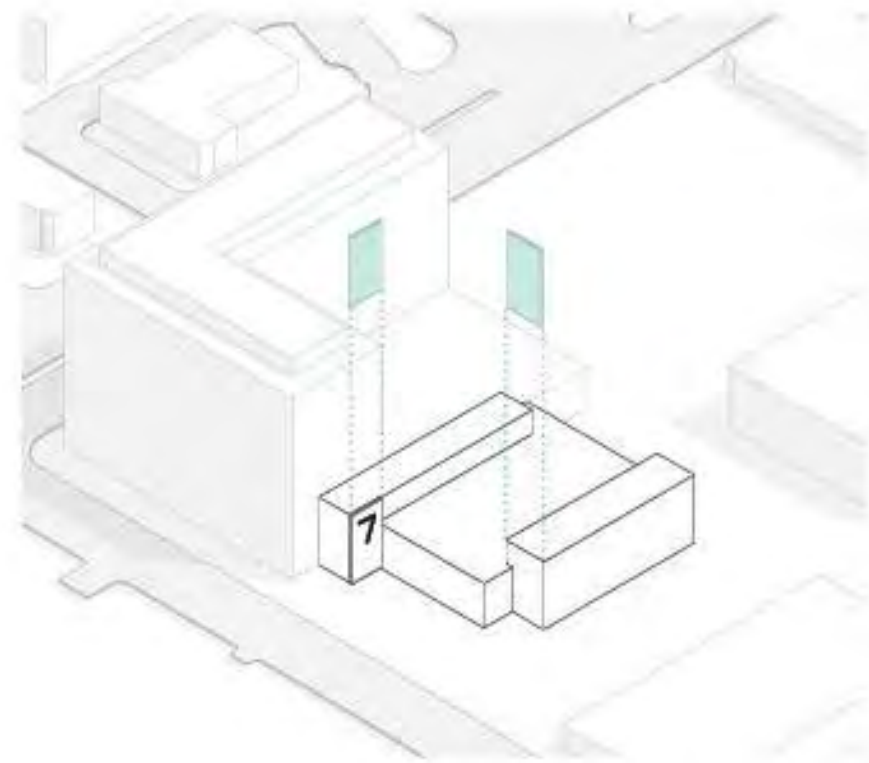

4 | STEP 4 - INSERT SIGNAGE TOWERS FOR IDENTITY

## EC7 | MASSING DIAGRAM



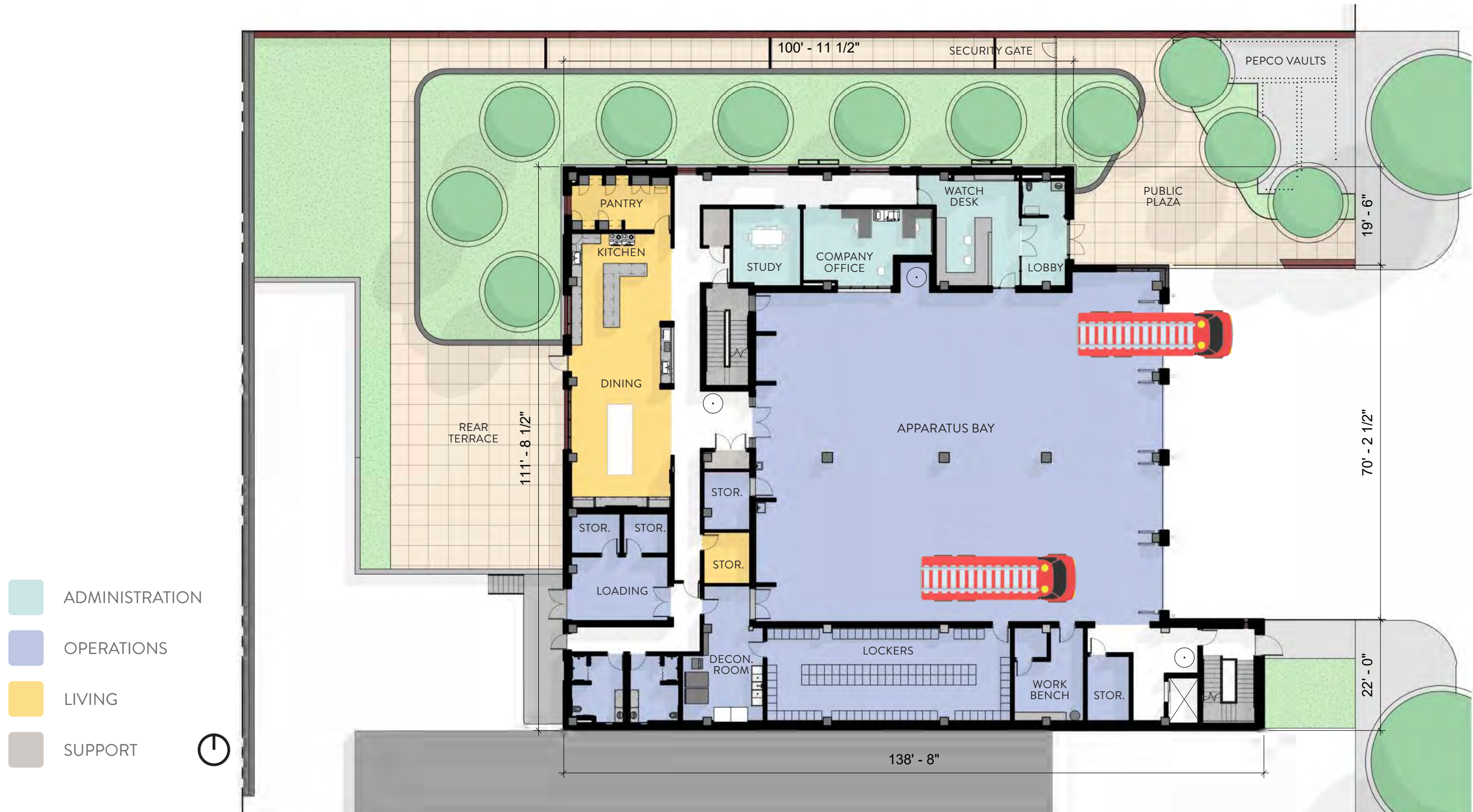

## EC 7 | FLOOR PLAN - LEVEL 1

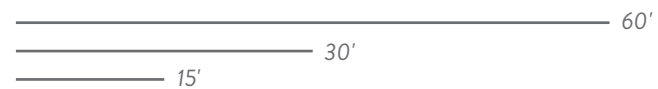

ENGINE COMPANY 7  
CFA PACKAGE | 18



fgma





EC 7 | FLOOR PLAN - LEVEL 2





## EC 7 | FLOOR PLAN - LEVEL 3

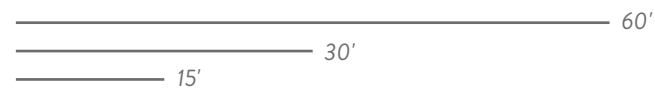



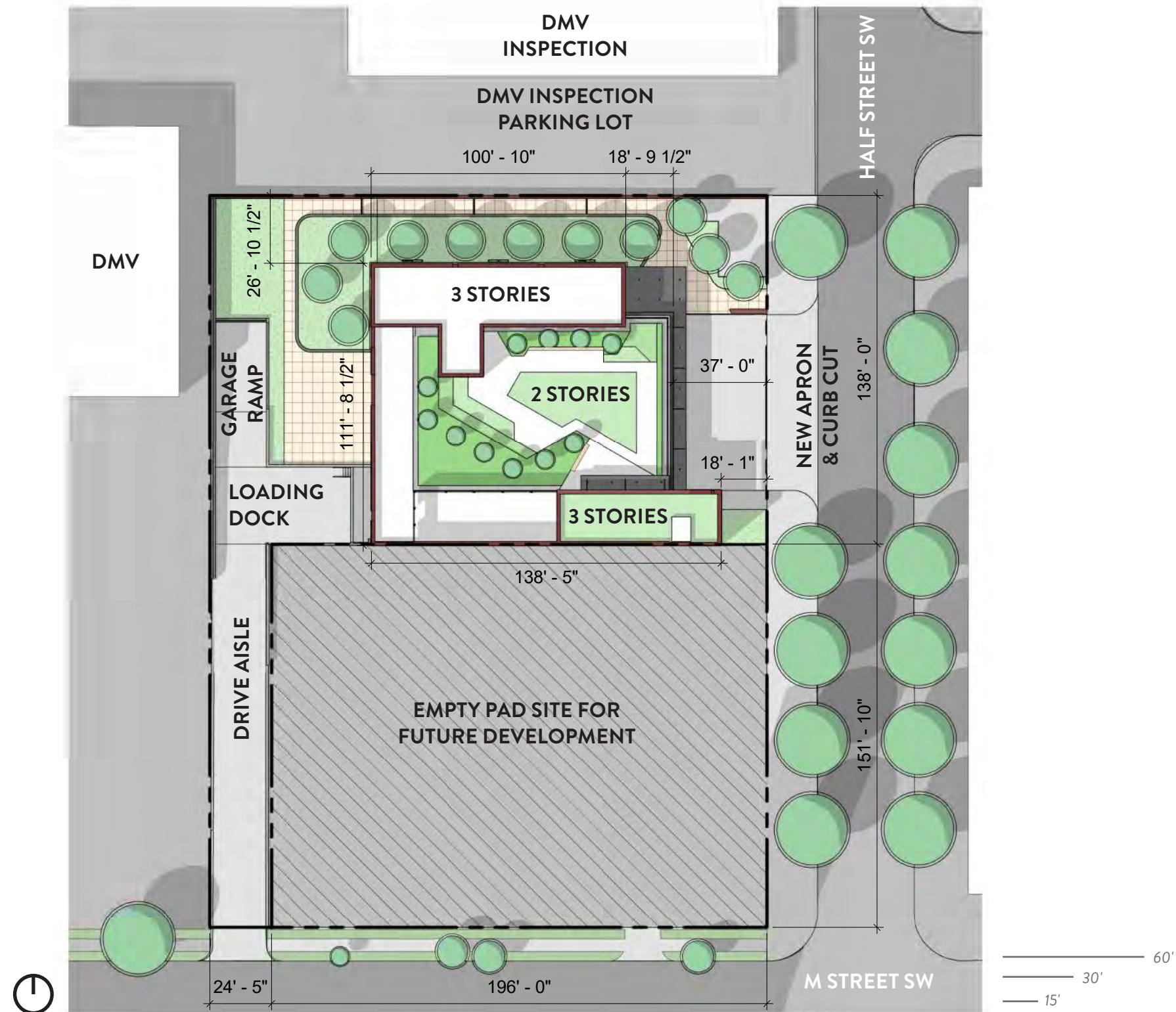

# EC 7 | PROPOSED SITE PLAN

SCALED TO 1" = 50'



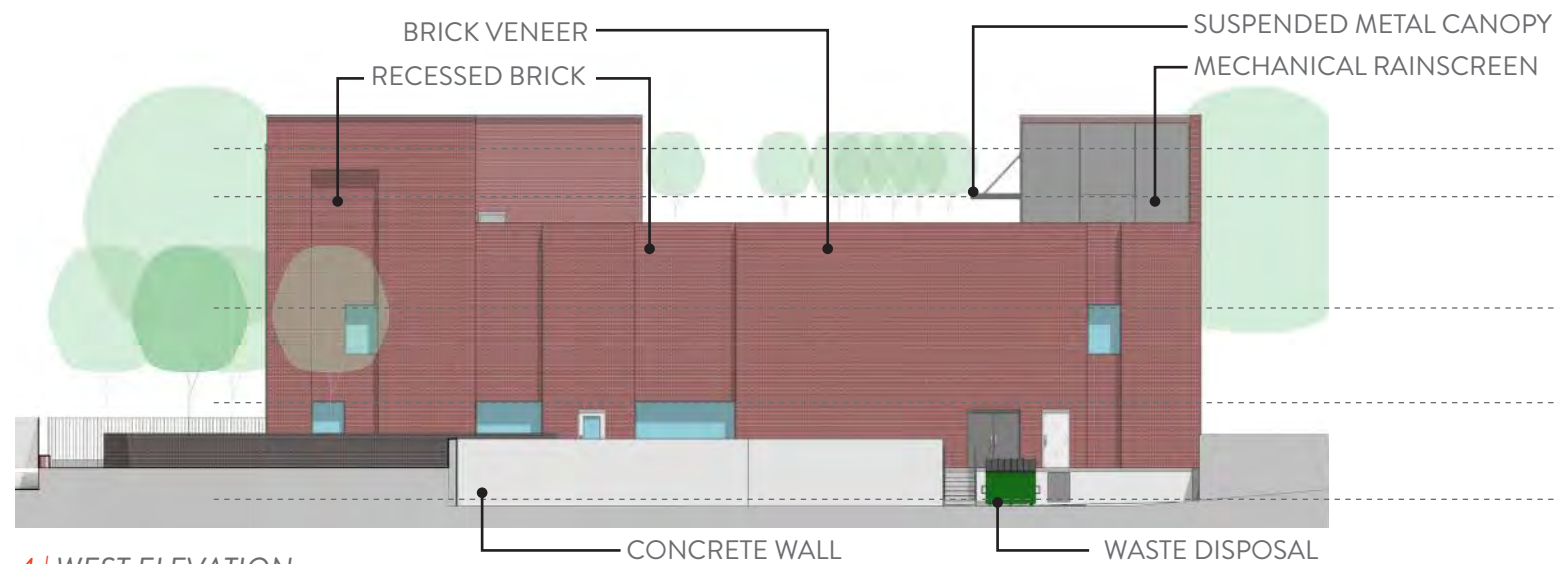

4 | WEST ELEVATION

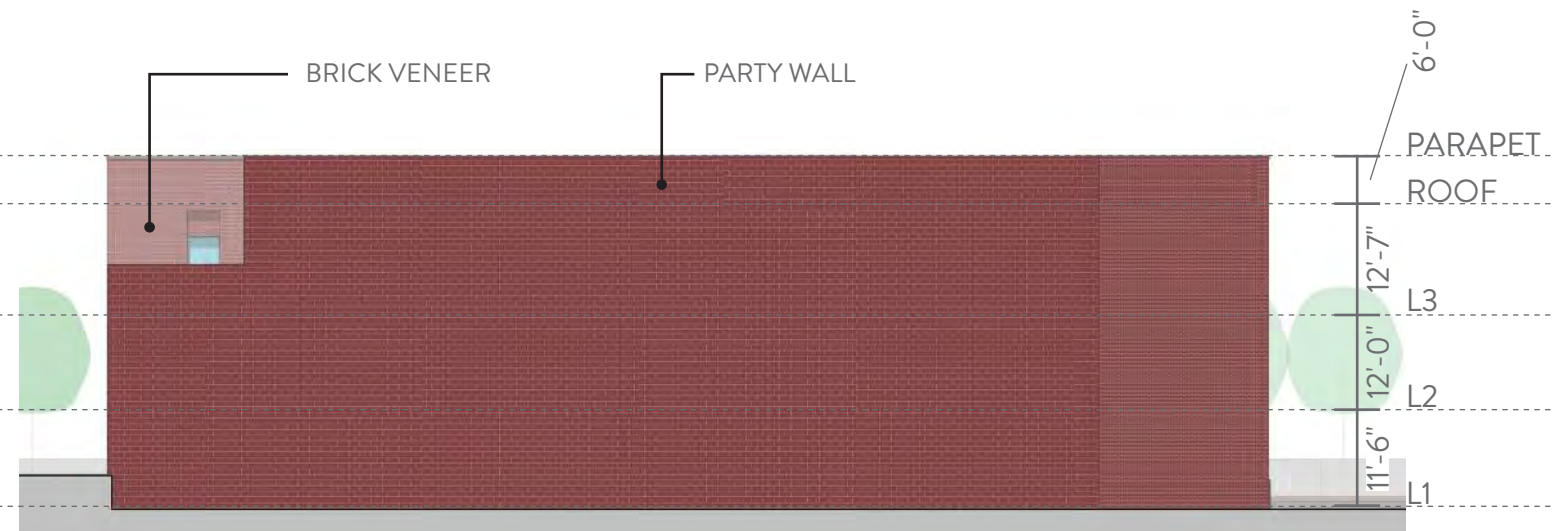

3 | SOUTH ELEVATION

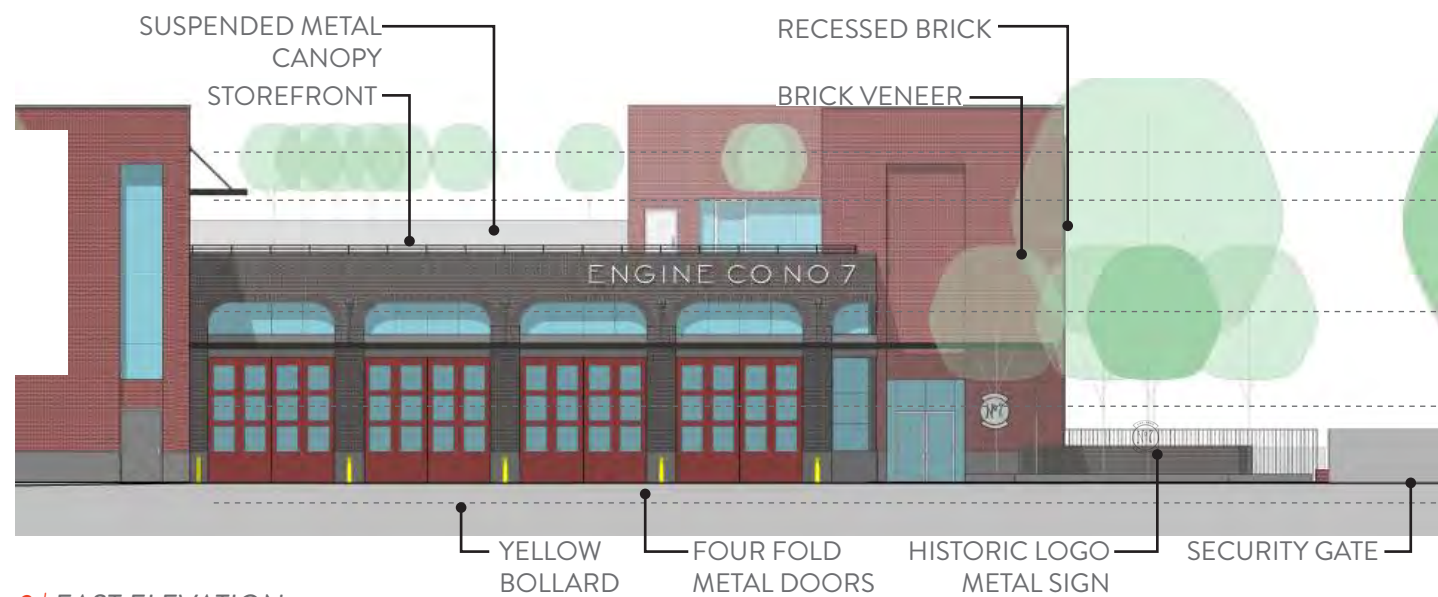

2 | EAST ELEVATION

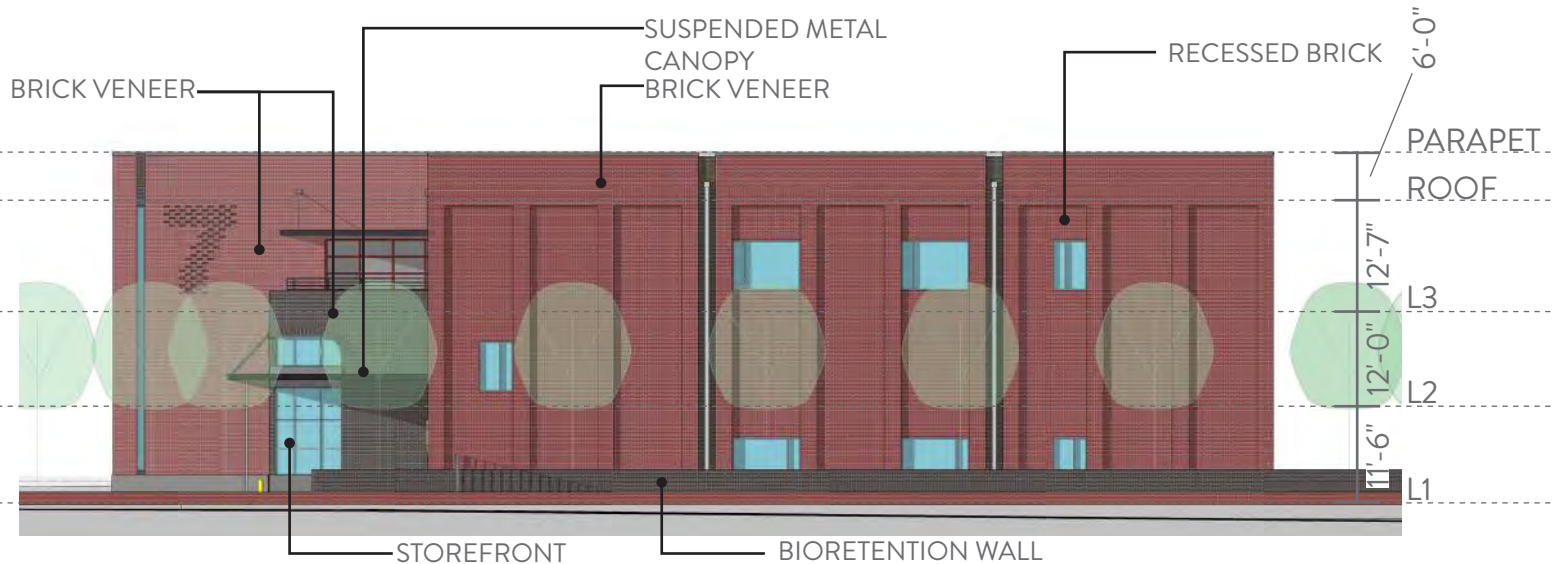

1 | NORTH ELEVATION

## EC7 | ELEVATIONS





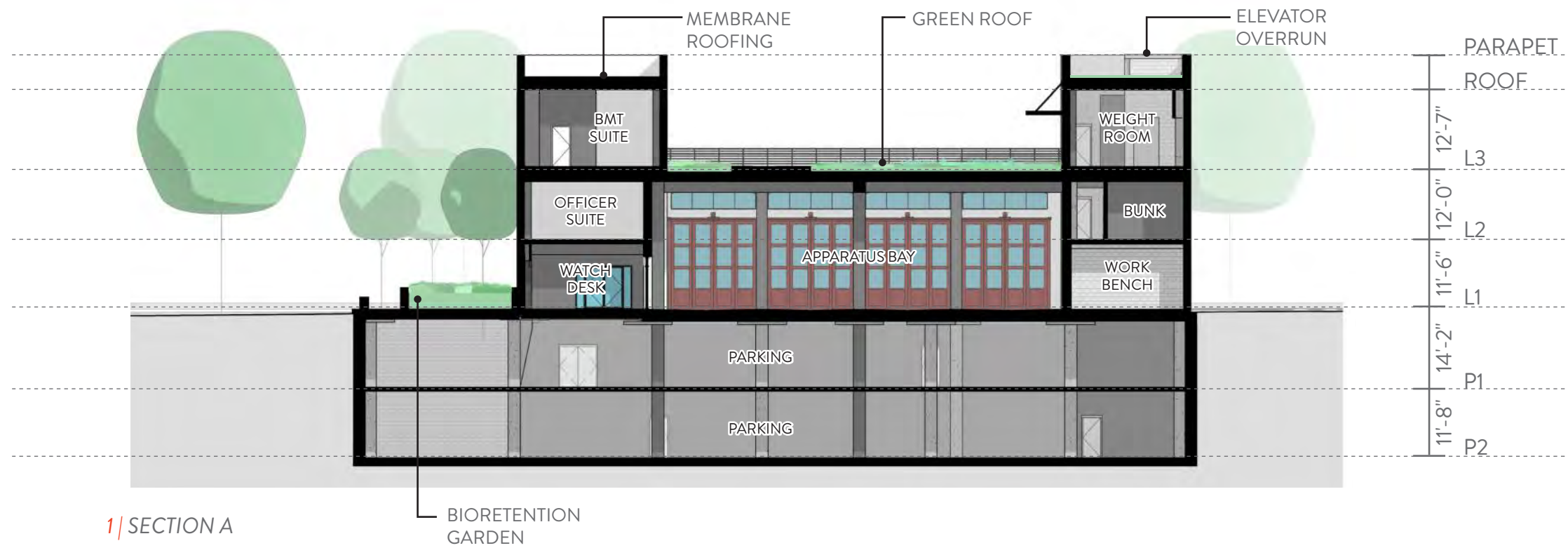

## EC 7 | BUILDING SECTIONS







- BLUE - TEMPORARY EC7
- ORANGE - EXISTING EC7
- GREY - FLEET MAINTENANCE

1/ STEP 1 - CONSTRUCT TEMPORARY EC7, DEMO EXISTING EC7



2/ STEP 2 - CONSTRUCT NEW EC7



3/ STEP 3 - DEMO TEMPORARY EC7

## EC7 | PROJECT PHASING



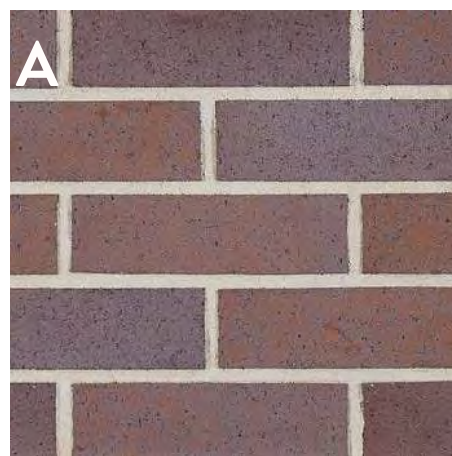
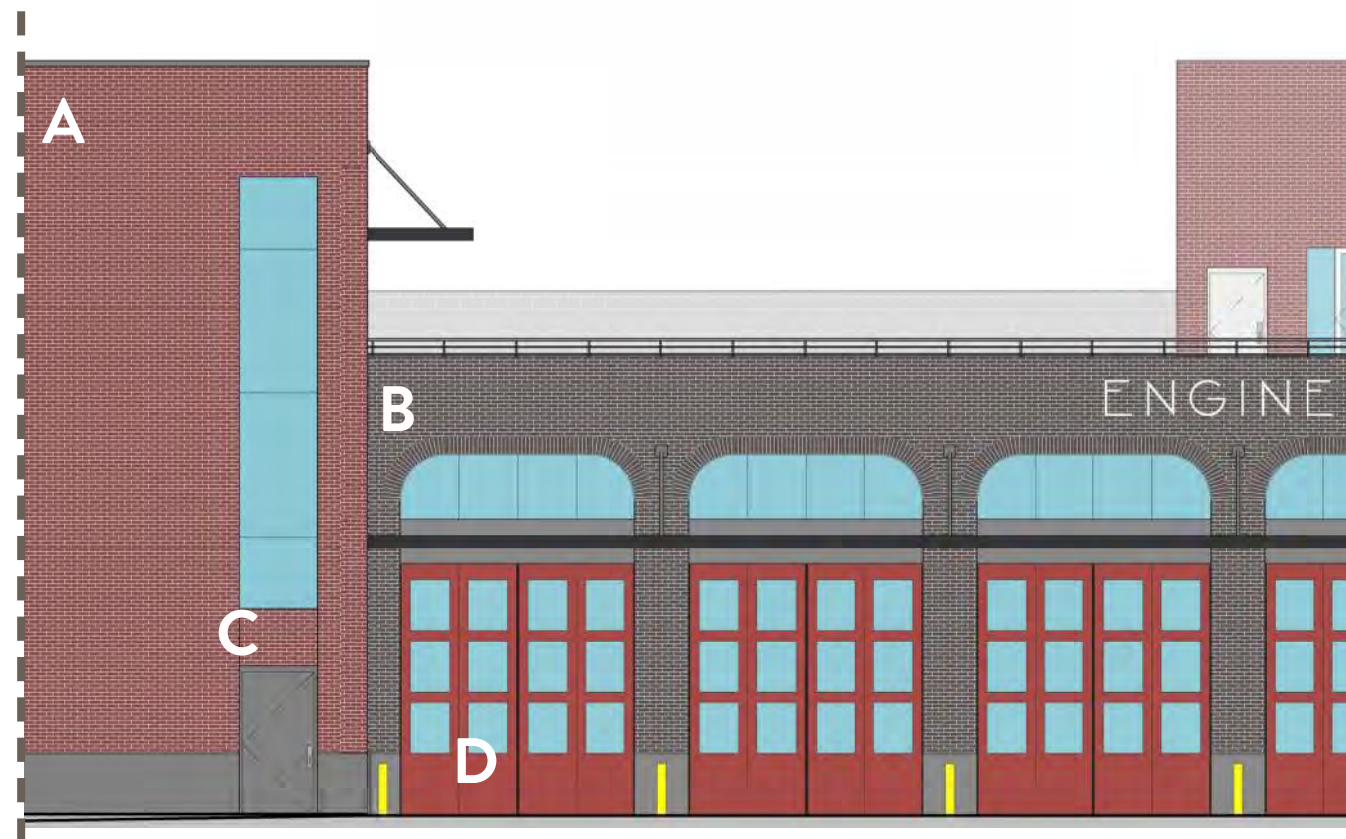

RED BRICK

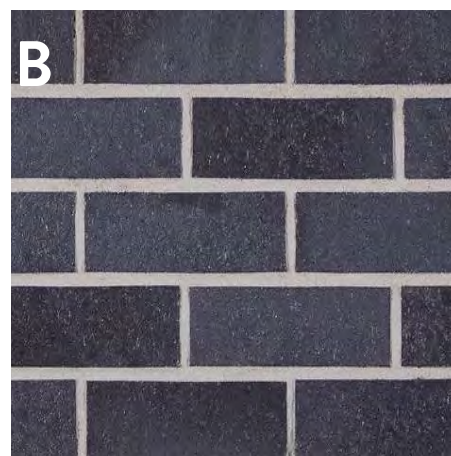

IRONSPOT BRICK



RECESSED BRICK PANELS



RED FOUR FOLD DOORS

## EC7 | MATERIAL SELECTIONS





## EC7 | NORTHEAST CORNER - NEW

ENGINE COMPANY 7  
CFA PACKAGE | 26



fgma







## EC7 | SOUTHEAST CORNER

ENGINE COMPANY 7  
CFA PACKAGE | 27



fgma







## EC7 | NORTHEAST CORNER - L STREET RE-OPENING

ENGINE COMPANY 7  
CFA PACKAGE | 28



fgma







## EC7 | LOOKING SOUTH - L STREET RE-OPENING

ENGINE COMPANY 7  
CFA PACKAGE | 29



fgma

